



June 19, 2023

Brent Perrin
Reynolds School District
1204 NE 201st Avenue
Fairview, Oregon 97024

Via email: BPerrin@rsd7.net

Regarding: Drinking Water Sampling Report
Salish Ponds Elementary School
1210 NE 201st Avenue
Fairview, OR
PBS Project 23514.186

Mr. Perrin:

In May 2023, PBS Engineering and Environmental Inc. (PBS) performed drinking water sampling and analysis for lead at Salish Ponds Elementary School in Portland, Oregon. The testing was requested by Reynolds School District (the District) to meet requirements from the Oregon Department of Education (ODE) and Oregon Health Authority (OHA) to conduct testing for lead in school drinking water systems.

Background and Sampling Procedure

Oregon Administrative Rule (OAR) 333-061-0400 *Reducing Lead In School Drinking Water* requires school districts to conduct initial testing for lead from each qualifying tap.

The sampling methodology followed the protocol described in Section 4 of the EPA document *3Ts for Reducing Lead in Drinking Water in Schools and Childcare Facilities, October 2018* and guidelines established by Oregon Health Authority and Oregon Department of Education. Following these guidelines, PBS assigned identification numbers and collected first draw samples from each test location. First draw samples consist of the first 250 milliliters (mL) of water drawn from a fixture during an early morning after school was in session the previous day, and before the fixture has been used again in the morning. The 3Ts' sampling protocol is designed to maximize the likelihood that the highest concentrations of lead in water used for consumption are identified.

PBS tested all taps in the building(s) eligible for testing according to OAR 333-061-0400, which requires testing of all taps except the following: shower heads, pipes used for building heating, dedicated eyewash stations and emergency showers, fixtures in areas with no student access used solely for sanitation by staff, fixtures used exclusively for irrigation, and fixtures in science and technical education classrooms (grades 6-12) where the fixtures have signage indicating they are not a drinking water source and are not intended for use in food preparation.

PBS assigned sample numbers to fixtures according to the ODE naming convention and using the ODE district and building codes provided by the District to PBS. When multiple samples were collected in the same area, PBS assigned numbers and sampled in a clockwise fashion starting on the left.

The District has previously completed some testing, but did not test all fixtures that are now required to be tested by ODE and did not use the sample naming convention now used by ODE, as ODE rules have changed since 2016.

Results

First draw samples were collected from 78 fixtures and delivered under chain of custody to Apex Laboratories in Tigard, Oregon, for lead analysis using EPA Method 200.8 ICPMS. An additional 2 fixtures were inventoried but could not be sampled. Samples above the action level of 15 ppb are shown in bold. The following table lists the results of the analysis.

Table 1: Salish Ponds Elementary School - Sample Results

Fixture Number	Sample Number	Location / Room No.	Fixture Type	Results (ppb)
001	22821700-001SF23A	Kitchen, staff handwashing	Staff faucet	2.26
002	22821700-002KF23A	Kitchen, SE food prep (east)	Kitchen faucet	17.3
003	22821700-003KF23A	Kitchen, SE food prep (west)	Kitchen faucet	10.0
004	22821700-004KF23A	Kitchen, dishwashing	Kitchen faucet	0.678
005	22821700-005KF23A	Kitchen, south, west sink	Kitchen faucet	0.686
006	22821700-006SF23A	Kitchen, restroom	Staff faucet	1.06
007	22821700-007BF23A	Cafeteria west bathroom	Bathroom faucet	3.41
008	22821700-008BF23A	Cafeteria south bathroom	Bathroom faucet	1.09
009	22821700-009DW23A	Cafeteria (left)	Drinking fountain	ND
010	22821700-010WB23A	Cafeteria	Water bottle fill	ND
011	22821700-011DW23A	Cafeteria (right)	Drinking fountain	ND
012	22821700-012BF23A	Girl's restroom, south hallway (south)	Bathroom faucet	9.03
013	22821700-013BF23A	Girl's restroom, south hallway (center)	Bathroom faucet	4.39
014	22821700-014BF23A	Girl's restroom, south hallway (north)	Bathroom faucet	4.58
015	22821700-015BF23A	Restroom, east hallway (left)	Bathroom faucet	0.923
016	22821700-016BF23A	Restroom, east hallway (right)	Bathroom faucet	3.66
017	22821700-017CF23A	Room 9	Classroom faucet	1.24
018	22821700-018CF23A	Room 11	Classroom faucet	2.22
019	22821700-019DW23A	Hall near Room 11	Drinking fountain	ND
020	22821700-020WB23A	Hall near Room 11	Water bottle fill	ND
021	22821700-021CF23A	Room 13	Classroom faucet	0.921
022	22821700-022CF23A	Room 15	Classroom faucet	1.92
023	22821700-023CF23A	Room 14	Classroom faucet	1.02
024	22821700-024CF23A	Room 12	Classroom faucet	1.09
025	22821700-025CF23A	Room 10	Classroom faucet	1.06
026	22821700-026CF23A	Room 2	Classroom faucet	2.05
027	22821700-027CF23A	Room 4	Classroom faucet	0.861
028	22821700-028DW23A	Hall near Room 4	Drinking fountain	ND
029	22821700-029WB23A	Hall near Room 4	Water bottle fill	ND
030	22821700-030CF23A	Room 6	Classroom faucet	1.91
031	22821700-031CF23A	Room 7	Classroom faucet	1.15

Fixture Number	Sample Number	Location / Room No.	Fixture Type	Results (ppb)
032	22821700-032CF23A	Room 5	Classroom faucet	1.12
033	22821700-033CF23A	Room 3	Classroom faucet	1.19
034	22821700-034CF23A	Room 1	Classroom faucet	1.42
035	22821700-035OT23A	Utility sink in commons hallway	Other (Utility Sink)	2.38
036	22821700-036BF23A	Commons hallway girl's restroom (north)	Bathroom faucet	0.690
037	22821700-037BF23A	Commons hallway girl's restroom (center)	Bathroom faucet	1.00
038	22821700-038BF23A	Commons hallway girl's restroom (south)	Bathroom faucet	1.60
039	22821700-039DW23A	Common hallway, north	Drinking fountain	ND
040	22821700-040WB23A	Common hallway, north	Water bottle fill	ND
041	22821700-041BF23A	Common hallway boy's restroom (north)	Bathroom faucet	0.586
042	22821700-042BF23A	Common hallway boy's restroom (center)	Bathroom faucet	1.19
043	22821700-043BF23A	Common hallway boy's restroom (south)	Bathroom faucet	1.79
044	22821700-044WB23A	Main office	Water bottle fill	ND
045	22821700-045NS23A	Nurses office restroom	Nurses sink	0.204
046	22821700-046CF23A	Room 19	Classroom faucet	2.55
047	22821700-047CF23A	Room 20	Classroom faucet	1.93
048	22821700-048SF23A	Teachers lounge	Staff faucet	0.578
049	22821700-049WB23A	Teachers lounge	Water bottle fill	ND
050	22821700-050SF23A	Teachers lounge restroom	Staff faucet	0.550
051	22821700-051BF23A	Room 18 bathroom	Bathroom faucet	0.705
052	22821700-052DW23A	Room 18	Drinking fountain	0.441
053	22821700-053CF23A	Room 18	Classroom faucet	0.695
054	22821700-054CF23A	Room 17	Classroom faucet	1.88
057	22821700-057BF23A	West hallway girls' restroom (south sink)	Bathroom faucet	1.15
058	22821700-058BF23A	West hallway girls' restroom (south sink)	Bathroom faucet	0.921
059	22821700-059BF23A	West hallway girls' restroom (north sink)	Bathroom faucet	0.635
060	22821700-060BF23A	West hallway girls' restroom (north sink)	Bathroom faucet	0.909
061	22821700-061WB23A	West hallway	Water bottle fill	ND
062	22821700-062DW23A	West hallway	Drinking fountain	ND
063	22821700-063BF23A	West hallway boy's restroom (south sink)	Bathroom faucet	1.07
064	22821700-064BF23A	West hallway boy's restroom (south sink)	Bathroom faucet	0.870
065	22821700-065BF23A	West hallway boy's restroom (north sink)	Bathroom faucet	0.827
066	22821700-066BF23A	West hallway boy's restroom (north sink)	Bathroom faucet	0.292
067	22821700-067BF23A	Upstairs boy's restroom (south sink)	Bathroom faucet	1.42
068	22821700-068BF23A	Upstairs boy's restroom (south sink)	Bathroom faucet	1.34
069	22821700-069BF23A	Upstairs boy's restroom (north sink)	Bathroom faucet	1.23
070	22821700-070BF23A	Upstairs boy's restroom (north sink)	Bathroom faucet	0.570
071	22821700-071WB23A	Upstairs hallway	Water bottle fill	ND
072	22821700-072DW23A	Upstairs hallway	Drinking fountain	ND
073	22821700-073BF23A	Upstairs girls' restroom (south sink)	Bathroom faucet	2.57
074	22821700-074BF23A	Upstairs girls' restroom (south sink)	Bathroom faucet	2.12

Fixture Number	Sample Number	Location / Room No.	Fixture Type	Results (ppb)
075	22821700-075BF23A	Upstairs girls' restroom (north sink)	Bathroom faucet	1.81
076	22821700-076BF23A	Upstairs girls' restroom (north sink)	Bathroom faucet	0.678
077	22821700-077CF23A	Room 23	Classroom faucet	2.05
078	22821700-078CF23A	Room 24	Classroom faucet	0.954
079	22821700-079CF23A	Room 26	Classroom faucet	1.47
080	22821700-080CF23A	Room 25	Classroom faucet	5.61

ND = no lead detected

The following is a list of fixtures that could not be sampled by PBS, as they were either shut off or inaccessible. PBS assigned them a number in sequence so they can be sampled later if they are brought back online.

Table 2: Salish Ponds Elementary School – Fixtures Not Sampled

Fixture Number	Sample Number	Location / Room No.	Fixture Type
055	22821700-055WB	Gym hall	Water bottle fill
056	22821700-056DW	Gym hall	Drinking fountain

Elevated concentrations of lead were found in one fixture in the building. Access to this fixture should be restricted in accordance with Oregon and EPA guidelines. PBS recommends taking corrective action per recommendations in EPA's 3Ts Module 6. Given that the majority of fixtures in the building tested below 15.0, it is unlikely that there is a building-wide source of lead in drinking water beyond the fixtures themselves. However, EPA protocol recommends follow-up flush sampling at all locations where first-draw samples contain lead concentrations greater than 15 parts per billion (ppb). PBS also recommends either remediating the fixture or installing a local filter, then flushing it and retesting in accordance with ODE guidelines. PBS is available to assist with further investigation and corrective actions upon request.

Please refer to the attached sample location field drawing and laboratory analytical report for additional details. The laboratory analytical results are reported in micrograms per liter (µg/L), a unit of measure that is equivalent to ppb.

Reimbursement

The District may be eligible for reimbursement from the State of Oregon for the cost of laboratory analytical testing and shipping, but not consultant fees. This is done by completing out the ODE's reimbursement template spreadsheet for each facility and submitting the information to ODE. PBS is available to assist with filing for reimbursement upon request, but it is not currently in our scope of work.

Ongoing Testing

According to OAR 333-061-0400, school districts are required to complete on-going testing at least once every six years, starting from July 1, 2020. Taps are exempt from ongoing testing if the tap was installed after January 4, 2014 and meets the lead-free standard of no more than 0.25 percent lead by weight and the piping feeding the tap is a material other than copper or was installed after January 4, 2014 and the solder and flux meets the leadfree standard of no more than 0.2 percent lead; and was tested during initial testing and results were less than 1 ppb lead. The District should investigate whether any taps at this facility meet the requirements to suspend ongoing testing. The District should consult with ODE to determine when they should complete ongoing testing.

Please feel free to contact me at 503.515.7489 or james.mastanduno@pbsusa.com with any questions or comments.

Sincerely,

A handwritten signature in black ink, appearing to read 'JM', with a stylized flourish extending to the right.

James Mastanduno
Project Manager

Attachments: Fixture Location Map
Laboratory Analytical Report

GENERAL NOTES

- 1. THIS DRAWING IS DIAGRAMMATIC. IT IS INTENDED TO SHOW OUTLET NUMBERS AND LOCATIONS RELATED TO DRINKING WATER SAMPLING.
- 2. IN SPACES WITH MULTIPLE OUTLETS, OUTLETS ARE NUMBERED CLOCKWISE FROM MAIN ENTRANCE UNLESS OTHERWISE SHOWN.

WATER OUTLET SYMBOLS

- ⊕ 007 — DRAWING REFERENCE TO WATER OUTLET LOCATION
- WATER OUTLET SYMBOL

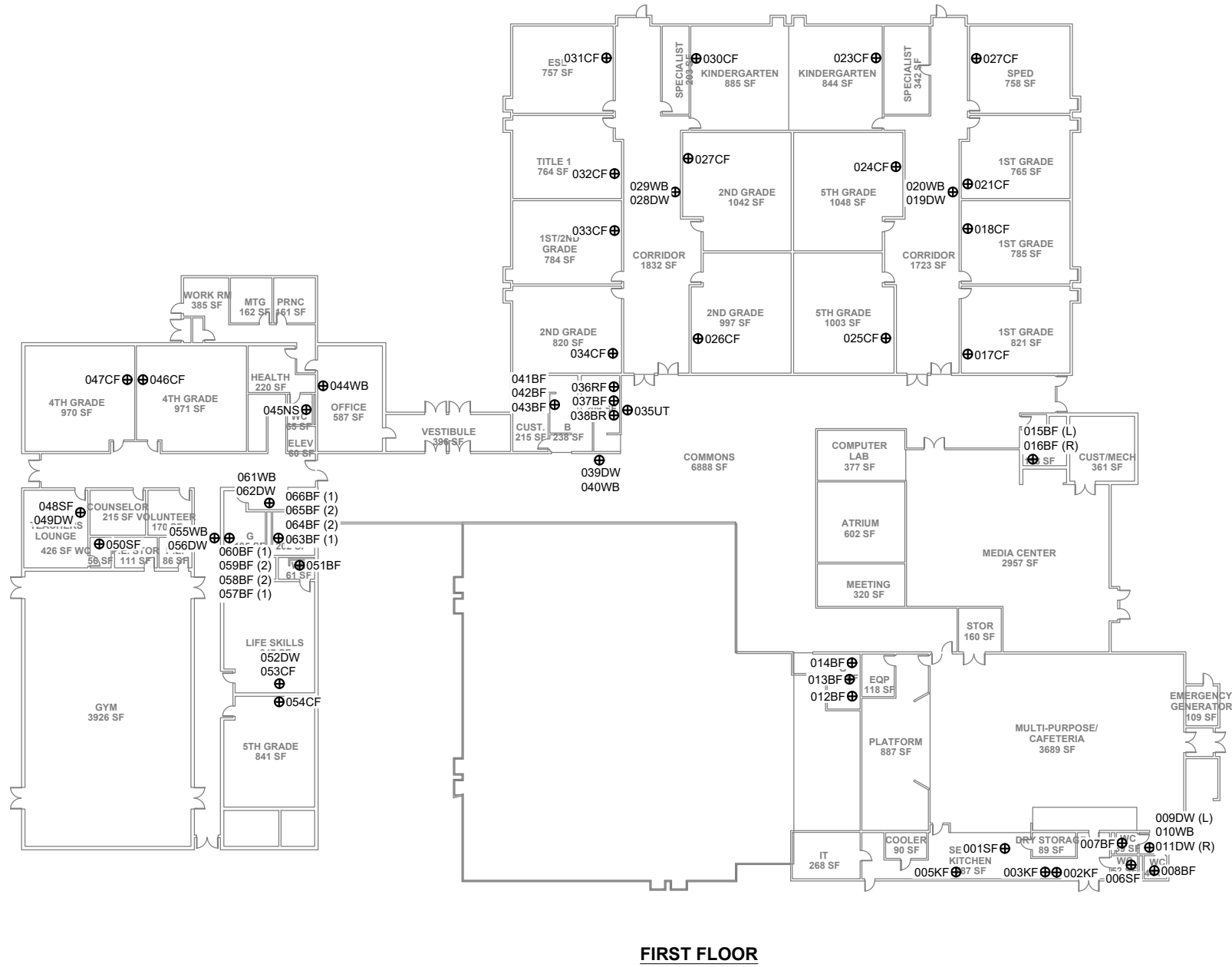

FIRST FLOOR



SCALE: 1" = 20'
0 10' 20' 40'

PBS Engineering and
Construction
4412 SW Cooper Avenue
Portland, OR 97239
503.248.1039
pbsca.com



DRINKING WATER FIXTURE LOCATION PLAN
SALISH PONDS ELEMENTARY SCHOOL
 1210 NE 201ST AVENUE #9642, FAIRVIEW, OREGON

NO.	REVISION	DATE	BY	APP'D

DRAWN BY: JAB
 CHECKED: JH
 DATE: MAY 2023
 PROJECT NUMBER: 23514.186 0001 006
 SHEET DRAWING NO:

DW1
 SHEET 1 OF 2

Filename: L:\Projects\23000\23500\23590\23514_186_2023_WaterCAD\DW1.dwg User: Jim Blanco CAD Plot Date/Time: 5/31/2023 10:18:21 AM Layout Tab: 11X17

FULL SIZE SHEET FORMAT IS 24X36; IF PRINTED SIZE IS NOT 24X36, THEN THIS SHEET FORMAT HAS BEEN MODIFIED & INDICATED DRAWING SCALE IS NOT ACCURATE.

GENERAL NOTES

1. THIS DRAWING IS DIAGRAMMATIC. IT IS INTENDED TO SHOW OUTLET NUMBERS AND LOCATIONS RELATED TO DRINKING WATER SAMPLING.
2. IN SPACES WITH MULTIPLE OUTLETS, OUTLETS ARE NUMBERED CLOCKWISE FROM MAIN ENTRANCE UNLESS OTHERWISE SHOWN.

WATER OUTLET SYMBOLS

- ⊕ 007 — DRAWING REFERENCE TO WATER OUTLET LOCATION
- WATER OUTLET SYMBOL

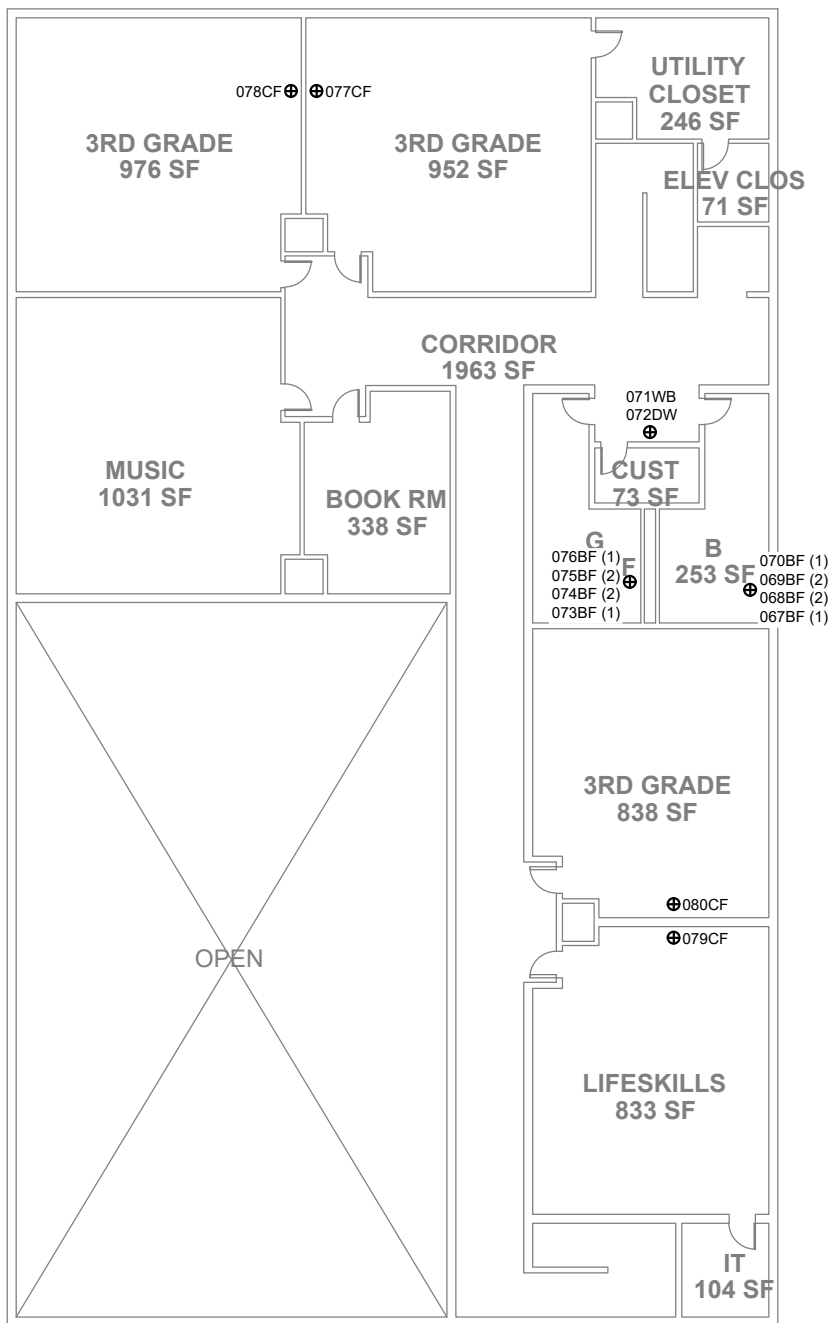

SECOND FLOOR



SCALE: 1" = 10'
 0 5' 10' 20'

PBS Engineering and
 Architecture
 4412 SW Canyon Avenue
 Portland, OR 97239
 503.248.1939
 pbsusa.com



DRINKING WATER FIXTURE LOCATION PLAN
SALISH PONDS ELEMENTARY SCHOOL
 1210 NE 201ST AVENUE #9642, FAIRVIEW, OREGON

NO	REVISION	DATE	BY	APPD

DRAWN BY
 JAB
 CHECKED:
 JH
 DATE:
 MAY 2023
 PROJECT NUMBER:
 23514.186 0001 006

SHEET DRAWING NO:
DW2
 SHEET 2 OF 2

Filename: L:\Projects\23000\23500\23514_Reynolds\23514_186_2023_Water\CAD\DWG_SALISH_PONDS\23514_186_001_006_DW2.dwg Layout Tab: 1TX17 User: Jim Blanco CAD Plot Date/Time: 5/31/2023 10:55:44 AM

FULL SIZE SHEET FORMAT IS 24X36; IF PRINTED SIZE IS NOT 24X36, THEN THIS SHEET FORMAT HAS BEEN MODIFIED & INDICATED DRAWING SCALE IS NOT ACCURATE.



ANALYTICAL REPORT

Apex Laboratories, LLC
6700 S.W. Sandburg Street
Tigard, OR 97223
503-718-2323
ORELAP ID: OR100062

Friday, June 16, 2023
James Mastanduno
PBS Engineering and Environmental
4412 S Corbett Ave
Portland, OR 97239

RE: A3E1862 - Reynolds School District - Salish Ponds/23514.186

Thank you for using Apex Laboratories. We greatly appreciate your business and strive to provide the highest quality services to the environmental industry.

Enclosed are the results of analyses for work order A3E1862, which was received by the laboratory on 5/30/2023 at 12:40:00PM.

If you have any questions concerning this report or the services we offer, please feel free to contact me by email at: jwoodcock@apex-labs.com, or by phone at 503-718-2323.

Please note: All samples will be disposed of within 30 days of sample receipt, unless prior arrangements have been made.

Cooler Receipt Information

(See Cooler Receipt Form for details)

Default Cooler 18.3 degC

This Final Report is the official version of the data results for this sample submission, unless superseded by a subsequent, labeled amended report.

All other deliverables derived from this data, including Electronic Data Deliverables (EDDs), CLP-like forms, client requested summary sheets, and all other products are considered secondary to this report.



Apex Laboratories

The results in this report apply to the samples analyzed in accordance with the chain of custody document. This analytical report must be reproduced in its entirety.

Jason Woodcock, Project Manager



ANALYTICAL REPORT

Apex Laboratories, LLC

6700 S.W. Sandburg Street
Tigard, OR 97223
503-718-2323
ORELAP ID: OR100062

<u>PBS Engineering and Environmental</u> 4412 S Corbett Ave Portland, OR 97239	Project: <u>Reynolds School District</u> Project Number: Salish Ponds/23514.186 Project Manager: James Mastanduno	Report ID: A3E1862 - 06 16 23 1641
---	--	--

ANALYTICAL REPORT FOR SAMPLES

SAMPLE INFORMATION

Client Sample ID	Laboratory ID	Matrix	Date Sampled	Date Received
22821700-001SF23A	A3E1862-01	Drinking Water	05/25/23 00:00	05/30/23 12:40
22821700-002KF23A	A3E1862-02	Drinking Water	05/25/23 00:00	05/30/23 12:40
22821700-003KF23A	A3E1862-03	Drinking Water	05/25/23 00:00	05/30/23 12:40
22821700-004KF23A	A3E1862-04	Drinking Water	05/25/23 00:00	05/30/23 12:40
22821700-005KF23A	A3E1862-05	Drinking Water	05/25/23 00:00	05/30/23 12:40
22821700-006SF23A	A3E1862-06	Drinking Water	05/25/23 00:00	05/30/23 12:40
22821700-007BF23A	A3E1862-07	Drinking Water	05/25/23 00:00	05/30/23 12:40
22821700-008BF23A	A3E1862-08	Drinking Water	05/25/23 00:00	05/30/23 12:40
22821700-009DW23A	A3E1862-09	Drinking Water	05/25/23 00:00	05/30/23 12:40
22821700-010WB23A	A3E1862-10	Drinking Water	05/25/23 00:00	05/30/23 12:40
22821700-011DW23A	A3E1862-11	Drinking Water	05/25/23 00:00	05/30/23 12:40
22821700-012BF23A	A3E1862-12	Drinking Water	05/25/23 00:00	05/30/23 12:40
22821700-013BF23A	A3E1862-13	Drinking Water	05/25/23 00:00	05/30/23 12:40
22821700-014BF23A	A3E1862-14	Drinking Water	05/25/23 00:00	05/30/23 12:40
22821700-015BF23A	A3E1862-15	Drinking Water	05/25/23 00:00	05/30/23 12:40
22821700-016BF23A	A3E1862-16	Drinking Water	05/25/23 00:00	05/30/23 12:40
22821700-017CF23A	A3E1862-17	Drinking Water	05/25/23 00:00	05/30/23 12:40
22821700-018CF23A	A3E1862-18	Drinking Water	05/25/23 00:00	05/30/23 12:40
22821700-019DW23A	A3E1862-19	Drinking Water	05/25/23 00:00	05/30/23 12:40
22821700-020WB23A	A3E1862-20	Drinking Water	05/25/23 00:00	05/30/23 12:40
22821700-021CF23A	A3E1862-21	Drinking Water	05/25/23 00:00	05/30/23 12:40
22821700-022CF23A	A3E1862-22	Drinking Water	05/25/23 00:00	05/30/23 12:40
22821700-023CF23A	A3E1862-23	Drinking Water	05/25/23 00:00	05/30/23 12:40
22821700-024CF23A	A3E1862-24	Drinking Water	05/25/23 00:00	05/30/23 12:40
22821700-025CF23A	A3E1862-25	Drinking Water	05/25/23 00:00	05/30/23 12:40
22821700-026CF23A	A3E1862-26	Drinking Water	05/25/23 00:00	05/30/23 12:40
22821700-027CF23A	A3E1862-27	Drinking Water	05/25/23 00:00	05/30/23 12:40
22821700-028DW23A	A3E1862-28	Drinking Water	05/25/23 00:00	05/30/23 12:40
22821700-029WB23A	A3E1862-29	Drinking Water	05/25/23 00:00	05/30/23 12:40
22821700-030CF23A	A3E1862-30	Drinking Water	05/25/23 00:00	05/30/23 12:40
22821700-031CF23A	A3E1862-31	Drinking Water	05/25/23 00:00	05/30/23 12:40
22821700-032CF23A	A3E1862-32	Drinking Water	05/25/23 00:00	05/30/23 12:40

Apex Laboratories

The results in this report apply to the samples analyzed in accordance with the chain of custody document. This analytical report must be reproduced in its entirety.



ANALYTICAL REPORT

Apex Laboratories, LLC

6700 S.W. Sandburg Street
Tigard, OR 97223
503-718-2323
ORELAP ID: OR100062

PBS Engineering and Environmental 4412 S Corbett Ave Portland, OR 97239	Project: Reynolds School District Project Number: Salish Ponds/23514.186 Project Manager: James Mastanduno	Report ID: A3E1862 - 06 16 23 1641
--	---	--

ANALYTICAL REPORT FOR SAMPLES

SAMPLE INFORMATION

Client Sample ID	Laboratory ID	Matrix	Date Sampled	Date Received
22821700-033CF23A	A3E1862-33	Drinking Water	05/25/23 00:00	05/30/23 12:40
22821700-034CF23A	A3E1862-34	Drinking Water	05/25/23 00:00	05/30/23 12:40
22821700-035OT23A	A3E1862-35	Drinking Water	05/25/23 00:00	05/30/23 12:40
22821700-036BF23A	A3E1862-36	Drinking Water	05/25/23 00:00	05/30/23 12:40
22821700-037BF23A	A3E1862-37	Drinking Water	05/25/23 00:00	05/30/23 12:40
22821700-038BF23A	A3E1862-38	Drinking Water	05/25/23 00:00	05/30/23 12:40
22821700-039DW23A	A3E1862-39	Drinking Water	05/25/23 00:00	05/30/23 12:40
22821700-040WB23A	A3E1862-40	Drinking Water	05/25/23 00:00	05/30/23 12:40
22821700-041BF23A	A3E1862-41	Drinking Water	05/25/23 00:00	05/30/23 12:40
22821700-042BF23A	A3E1862-42	Drinking Water	05/25/23 00:00	05/30/23 12:40
22821700-043BF23A	A3E1862-43	Drinking Water	05/25/23 00:00	05/30/23 12:40
22821700-044WB23A	A3E1862-44	Drinking Water	05/25/23 00:00	05/30/23 12:40
22821700-045NS23A	A3E1862-45	Drinking Water	05/25/23 00:00	05/30/23 12:40
22821700-046CF23A	A3E1862-46	Drinking Water	05/25/23 00:00	05/30/23 12:40
22821700-047CF23A	A3E1862-47	Drinking Water	05/25/23 00:00	05/30/23 12:40
22821700-048SF23A	A3E1862-48	Drinking Water	05/25/23 00:00	05/30/23 12:40
22821700-049WB23A	A3E1862-49	Drinking Water	05/25/23 00:00	05/30/23 12:40
22821700-050SF23A	A3E1862-50	Drinking Water	05/25/23 00:00	05/30/23 12:40
22821700-051BF23A	A3E1862-51	Drinking Water	05/25/23 00:00	05/30/23 12:40
22821700-052DW23A	A3E1862-52	Drinking Water	05/25/23 00:00	05/30/23 12:40
22821700-053CF23A	A3E1862-53	Drinking Water	05/25/23 00:00	05/30/23 12:40
22821700-054CF23A	A3E1862-54	Drinking Water	05/25/23 00:00	05/30/23 12:40
22821700-057BF23A	A3E1862-55	Drinking Water	05/25/23 00:00	05/30/23 12:40
22821700-058BF23A	A3E1862-56	Drinking Water	05/25/23 00:00	05/30/23 12:40
22821700-059BF23A	A3E1862-57	Drinking Water	05/25/23 00:00	05/30/23 12:40
22821700-060BF23A	A3E1862-58	Drinking Water	05/25/23 00:00	05/30/23 12:40
22821700-061WB23A	A3E1862-59	Drinking Water	05/25/23 00:00	05/30/23 12:40
22821700-062DW23A	A3E1862-60	Drinking Water	05/25/23 00:00	05/30/23 12:40
22821700-063BF23A	A3E1862-61	Drinking Water	05/25/23 00:00	05/30/23 12:40
22821700-064BF23A	A3E1862-62	Drinking Water	05/25/23 00:00	05/30/23 12:40
22821700-065BF23A	A3E1862-63	Drinking Water	05/25/23 00:00	05/30/23 12:40
22821700-066BF23A	A3E1862-64	Drinking Water	05/25/23 00:00	05/30/23 12:40

Apex Laboratories

The results in this report apply to the samples analyzed in accordance with the chain of custody document. This analytical report must be reproduced in its entirety.



ANALYTICAL REPORT

Apex Laboratories, LLC

6700 S.W. Sandburg Street
Tigard, OR 97223
503-718-2323
ORELAP ID: OR100062

<u>PBS Engineering and Environmental</u> 4412 S Corbett Ave Portland, OR 97239	Project: <u>Reynolds School District</u> Project Number: Salish Ponds/23514.186 Project Manager: James Mastanduno	Report ID: A3E1862 - 06 16 23 1641
---	--	---

ANALYTICAL REPORT FOR SAMPLES

SAMPLE INFORMATION

Client Sample ID	Laboratory ID	Matrix	Date Sampled	Date Received
22821700-067BF23A	A3E1862-65	Drinking Water	05/25/23 00:00	05/30/23 12:40
22821700-068BF23A	A3E1862-66	Drinking Water	05/25/23 00:00	05/30/23 12:40
22821700-069BF23A	A3E1862-67	Drinking Water	05/25/23 00:00	05/30/23 12:40
22821700-070BF23A	A3E1862-68	Drinking Water	05/25/23 00:00	05/30/23 12:40
22821700-071WB23A	A3E1862-69	Drinking Water	05/25/23 00:00	05/30/23 12:40
22821700-072DW23A	A3E1862-70	Drinking Water	05/25/23 00:00	05/30/23 12:40
22821700-073BF23A	A3E1862-71	Drinking Water	05/25/23 00:00	05/30/23 12:40
22821700-074BF23A	A3E1862-72	Drinking Water	05/25/23 00:00	05/30/23 12:40
22821700-075BF23A	A3E1862-73	Drinking Water	05/25/23 00:00	05/30/23 12:40
22821700-076BF23A	A3E1862-74	Drinking Water	05/25/23 00:00	05/30/23 12:40
22821700-077CF23A	A3E1862-75	Drinking Water	05/25/23 00:00	05/30/23 12:40
22821700-078CF23A	A3E1862-76	Drinking Water	05/25/23 00:00	05/30/23 12:40
22821700-079CF23A	A3E1862-77	Drinking Water	05/25/23 00:00	05/30/23 12:40
22821700-080CF23A	A3E1862-78	Drinking Water	05/25/23 00:00	05/30/23 12:40

Apex Laboratories

The results in this report apply to the samples analyzed in accordance with the chain of custody document. This analytical report must be reproduced in its entirety.

Jason Woodcock, Project Manager



ANALYTICAL REPORT

Apex Laboratories, LLC

6700 S.W. Sandburg Street
Tigard, OR 97223
503-718-2323
ORELAP ID: OR100062

PBS Engineering and Environmental 4412 S Corbett Ave Portland, OR 97239	Project: Reynolds School District Project Number: Salish Ponds/23514.186 Project Manager: James Mastanduno	Report ID: A3E1862 - 06 16 23 1641
--	---	---

ANALYTICAL SAMPLE RESULTS

Total Metals in Drinking Water by EPA 200.8 (ICPMS)

Analyte	Sample Result	Detection Limit	Reporting Limit	Units	Dilution	Date Analyzed	Method Ref.	Notes
22821700-001SF23A (A3E1862-01)				Matrix: Drinking Water				
<u>Batch: 23F0444</u>								
Lead	2.26	---	0.200	ug/L	1	06/13/23 14:23	EPA 200.8	
22821700-002KF23A (A3E1862-02)				Matrix: Drinking Water				
<u>Batch: 23F0426</u>								
Lead	17.3	---	0.222	ug/L	1	06/14/23 00:33	EPA 200.8	DW-D
22821700-003KF23A (A3E1862-03)				Matrix: Drinking Water				
<u>Batch: 23F0426</u>								
Lead	10.0	---	0.222	ug/L	1	06/14/23 00:38	EPA 200.8	DW-D
22821700-004KF23A (A3E1862-04)				Matrix: Drinking Water				
<u>Batch: 23F0444</u>								
Lead	0.678	---	0.200	ug/L	1	06/13/23 14:24	EPA 200.8	
22821700-005KF23A (A3E1862-05)				Matrix: Drinking Water				
<u>Batch: 23F0444</u>								
Lead	0.686	---	0.200	ug/L	1	06/13/23 14:26	EPA 200.8	
22821700-006SF23A (A3E1862-06)				Matrix: Drinking Water				
<u>Batch: 23F0444</u>								
Lead	1.06	---	0.200	ug/L	1	06/13/23 14:27	EPA 200.8	
22821700-007BF23A (A3E1862-07)				Matrix: Drinking Water				
<u>Batch: 23F0444</u>								
Lead	3.41	---	0.200	ug/L	1	06/13/23 14:28	EPA 200.8	
22821700-008BF23A (A3E1862-08)				Matrix: Drinking Water				
<u>Batch: 23F0444</u>								
Lead	1.09	---	0.200	ug/L	1	06/13/23 14:30	EPA 200.8	
22821700-009DW23A (A3E1862-09)				Matrix: Drinking Water				
<u>Batch: 23F0444</u>								
Lead	ND	---	0.200	ug/L	1	06/13/23 14:31	EPA 200.8	
22821700-010WB23A (A3E1862-10)				Matrix: Drinking Water				

Apex Laboratories

Jason Woodcock, Project Manager

The results in this report apply to the samples analyzed in accordance with the chain of custody document. This analytical report must be reproduced in its entirety.



ANALYTICAL REPORT

Apex Laboratories, LLC

6700 S.W. Sandburg Street
Tigard, OR 97223
503-718-2323
ORELAP ID: OR100062

PBS Engineering and Environmental 4412 S Corbett Ave Portland, OR 97239	Project: Reynolds School District Project Number: Salish Ponds/23514.186 Project Manager: James Mastanduno	Report ID: A3E1862 - 06 16 23 1641
--	---	--

ANALYTICAL SAMPLE RESULTS

Total Metals in Drinking Water by EPA 200.8 (ICPMS)

Analyte	Sample Result	Detection Limit	Reporting Limit	Units	Dilution	Date Analyzed	Method Ref.	Notes
22821700-010WB23A (A3E1862-10)				Matrix: Drinking Water				
Batch: 23F0450								
Lead	ND	---	0.200	ug/L	1	06/13/23 14:40	EPA 200.8	
22821700-011DW23A (A3E1862-11)				Matrix: Drinking Water				
Batch: 23F0450								
Lead	ND	---	0.200	ug/L	1	06/13/23 14:44	EPA 200.8	
22821700-012BF23A (A3E1862-12)				Matrix: Drinking Water				
Batch: 23F0450								
Lead	9.03	---	0.200	ug/L	1	06/13/23 14:46	EPA 200.8	
22821700-013BF23A (A3E1862-13)				Matrix: Drinking Water				
Batch: 23F0450								
Lead	4.39	---	0.200	ug/L	1	06/13/23 14:47	EPA 200.8	
22821700-014BF23A (A3E1862-14)				Matrix: Drinking Water				
Batch: 23F0450								
Lead	4.58	---	0.200	ug/L	1	06/13/23 14:49	EPA 200.8	
22821700-015BF23A (A3E1862-15)				Matrix: Drinking Water				
Batch: 23F0450								
Lead	0.923	---	0.200	ug/L	1	06/13/23 14:50	EPA 200.8	
22821700-016BF23A (A3E1862-16)				Matrix: Drinking Water				
Batch: 23F0450								
Lead	3.66	---	0.200	ug/L	1	06/13/23 14:55	EPA 200.8	
22821700-017CF23A (A3E1862-17)				Matrix: Drinking Water				
Batch: 23F0450								
Lead	1.24	---	0.200	ug/L	1	06/13/23 14:56	EPA 200.8	
22821700-018CF23A (A3E1862-18)				Matrix: Drinking Water				
Batch: 23F0450								
Lead	2.22	---	0.200	ug/L	1	06/13/23 14:58	EPA 200.8	
22821700-019DW23A (A3E1862-19)				Matrix: Drinking Water				

Apex Laboratories

The results in this report apply to the samples analyzed in accordance with the chain of custody document. This analytical report must be reproduced in its entirety.

Jason Woodcock, Project Manager



ANALYTICAL REPORT

Apex Laboratories, LLC

6700 S.W. Sandburg Street
Tigard, OR 97223
503-718-2323
ORELAP ID: OR100062

PBS Engineering and Environmental 4412 S Corbett Ave Portland, OR 97239	Project: Reynolds School District Project Number: Salish Ponds/23514.186 Project Manager: James Mastanduno	Report ID: A3E1862 - 06 16 23 1641
--	---	---

ANALYTICAL SAMPLE RESULTS

Total Metals in Drinking Water by EPA 200.8 (ICPMS)

Analyte	Sample Result	Detection Limit	Reporting Limit	Units	Dilution	Date Analyzed	Method Ref.	Notes
22821700-019DW23A (A3E1862-19)				Matrix: Drinking Water				
<u>Batch: 23F0450</u>								
Lead	ND	---	0.200	ug/L	1	06/13/23 14:59	EPA 200.8	
22821700-020WB23A (A3E1862-20)				Matrix: Drinking Water				
<u>Batch: 23F0450</u>								
Lead	ND	---	0.200	ug/L	1	06/13/23 15:01	EPA 200.8	
22821700-021CF23A (A3E1862-21)				Matrix: Drinking Water				
<u>Batch: 23F0450</u>								
Lead	0.921	---	0.200	ug/L	1	06/13/23 15:02	EPA 200.8	
22821700-022CF23A (A3E1862-22)				Matrix: Drinking Water				
<u>Batch: 23F0450</u>								
Lead	1.92	---	0.200	ug/L	1	06/13/23 15:03	EPA 200.8	
22821700-023CF23A (A3E1862-23)				Matrix: Drinking Water				
<u>Batch: 23F0450</u>								
Lead	1.02	---	0.200	ug/L	1	06/13/23 15:05	EPA 200.8	
22821700-024CF23A (A3E1862-24)				Matrix: Drinking Water				
<u>Batch: 23F0450</u>								
Lead	1.09	---	0.200	ug/L	1	06/13/23 15:06	EPA 200.8	
22821700-025CF23A (A3E1862-25)				Matrix: Drinking Water				
<u>Batch: 23F0450</u>								
Lead	1.06	---	0.200	ug/L	1	06/13/23 15:08	EPA 200.8	
22821700-026CF23A (A3E1862-26)				Matrix: Drinking Water				
<u>Batch: 23F0450</u>								
Lead	2.05	---	0.200	ug/L	1	06/13/23 15:12	EPA 200.8	
22821700-027CF23A (A3E1862-27)				Matrix: Drinking Water				
<u>Batch: 23F0450</u>								
Lead	0.861	---	0.200	ug/L	1	06/13/23 15:14	EPA 200.8	
22821700-028DW23A (A3E1862-28)				Matrix: Drinking Water				

Apex Laboratories

The results in this report apply to the samples analyzed in accordance with the chain of custody document. This analytical report must be reproduced in its entirety.

Jason Woodcock, Project Manager



ANALYTICAL REPORT

Apex Laboratories, LLC

6700 S.W. Sandburg Street
Tigard, OR 97223
503-718-2323
ORELAP ID: OR100062

PBS Engineering and Environmental 4412 S Corbett Ave Portland, OR 97239	Project: Reynolds School District Project Number: Salish Ponds/23514.186 Project Manager: James Mastanduno	Report ID: A3E1862 - 06 16 23 1641
--	---	---

ANALYTICAL SAMPLE RESULTS

Total Metals in Drinking Water by EPA 200.8 (ICPMS)

Analyte	Sample Result	Detection Limit	Reporting Limit	Units	Dilution	Date Analyzed	Method Ref.	Notes
22821700-028DW23A (A3E1862-28)				Matrix: Drinking Water				
<u>Batch: 23F0450</u>								
Lead	ND	---	0.200	ug/L	1	06/13/23 15:15	EPA 200.8	
22821700-029WB23A (A3E1862-29)				Matrix: Drinking Water				
<u>Batch: 23F0450</u>								
Lead	ND	---	0.200	ug/L	1	06/13/23 15:17	EPA 200.8	
22821700-030CF23A (A3E1862-30)				Matrix: Drinking Water				
<u>Batch: 23F0465</u>								
Lead	1.91	---	0.200	ug/L	1	06/13/23 16:06	EPA 200.8	
22821700-031CF23A (A3E1862-31)				Matrix: Drinking Water				
<u>Batch: 23F0465</u>								
Lead	1.15	---	0.200	ug/L	1	06/13/23 16:10	EPA 200.8	
22821700-032CF23A (A3E1862-32)				Matrix: Drinking Water				
<u>Batch: 23F0465</u>								
Lead	1.12	---	0.200	ug/L	1	06/13/23 16:12	EPA 200.8	
22821700-033CF23A (A3E1862-33)				Matrix: Drinking Water				
<u>Batch: 23F0465</u>								
Lead	1.19	---	0.200	ug/L	1	06/13/23 16:13	EPA 200.8	
22821700-034CF23A (A3E1862-34)				Matrix: Drinking Water				
<u>Batch: 23F0465</u>								
Lead	1.42	---	0.200	ug/L	1	06/13/23 16:14	EPA 200.8	
22821700-035OT23A (A3E1862-35)				Matrix: Drinking Water				
<u>Batch: 23F0465</u>								
Lead	2.38	---	0.200	ug/L	1	06/13/23 16:16	EPA 200.8	
22821700-036BF23A (A3E1862-36)				Matrix: Drinking Water				
<u>Batch: 23F0465</u>								
Lead	0.690	---	0.200	ug/L	1	06/13/23 16:20	EPA 200.8	
22821700-037BF23A (A3E1862-37)				Matrix: Drinking Water				

Apex Laboratories

Jason Woodcock, Project Manager

The results in this report apply to the samples analyzed in accordance with the chain of custody document. This analytical report must be reproduced in its entirety.



ANALYTICAL REPORT

Apex Laboratories, LLC

6700 S.W. Sandburg Street
Tigard, OR 97223
503-718-2323
ORELAP ID: OR100062

PBS Engineering and Environmental 4412 S Corbett Ave Portland, OR 97239	Project: Reynolds School District Project Number: Salish Ponds/23514.186 Project Manager: James Mastanduno	Report ID: A3E1862 - 06 16 23 1641
--	---	--

ANALYTICAL SAMPLE RESULTS

Total Metals in Drinking Water by EPA 200.8 (ICPMS)

Analyte	Sample Result	Detection Limit	Reporting Limit	Units	Dilution	Date Analyzed	Method Ref.	Notes
22821700-037BF23A (A3E1862-37)				Matrix: Drinking Water				
Batch: 23F0465								
Lead	1.00	---	0.200	ug/L	1	06/13/23 16:22	EPA 200.8	
22821700-038BF23A (A3E1862-38)				Matrix: Drinking Water				
Batch: 23F0465								
Lead	1.60	---	0.200	ug/L	1	06/13/23 16:23	EPA 200.8	
22821700-039DW23A (A3E1862-39)				Matrix: Drinking Water				
Batch: 23F0465								
Lead	ND	---	0.200	ug/L	1	06/13/23 16:25	EPA 200.8	
22821700-040WB23A (A3E1862-40)				Matrix: Drinking Water				
Batch: 23F0465								
Lead	ND	---	0.200	ug/L	1	06/13/23 16:26	EPA 200.8	
22821700-041BF23A (A3E1862-41)				Matrix: Drinking Water				
Batch: 23F0465								
Lead	0.586	---	0.200	ug/L	1	06/13/23 16:28	EPA 200.8	
22821700-042BF23A (A3E1862-42)				Matrix: Drinking Water				
Batch: 23F0465								
Lead	1.19	---	0.200	ug/L	1	06/13/23 16:29	EPA 200.8	
22821700-043BF23A (A3E1862-43)				Matrix: Drinking Water				
Batch: 23F0465								
Lead	1.79	---	0.200	ug/L	1	06/13/23 16:31	EPA 200.8	
22821700-044WB23A (A3E1862-44)				Matrix: Drinking Water				
Batch: 23F0465								
Lead	ND	---	0.200	ug/L	1	06/13/23 16:32	EPA 200.8	
22821700-045NS23A (A3E1862-45)				Matrix: Drinking Water				
Batch: 23F0465								
Lead	0.204	---	0.200	ug/L	1	06/13/23 16:34	EPA 200.8	
22821700-046CF23A (A3E1862-46)				Matrix: Drinking Water				

Apex Laboratories

The results in this report apply to the samples analyzed in accordance with the chain of custody document. This analytical report must be reproduced in its entirety.

Jason Woodcock, Project Manager



ANALYTICAL REPORT

Apex Laboratories, LLC

6700 S.W. Sandburg Street
Tigard, OR 97223
503-718-2323
ORELAP ID: OR100062

PBS Engineering and Environmental 4412 S Corbett Ave Portland, OR 97239	Project: Reynolds School District Project Number: Salish Ponds/23514.186 Project Manager: James Mastanduno	Report ID: A3E1862 - 06 16 23 1641
--	---	---

ANALYTICAL SAMPLE RESULTS

Total Metals in Drinking Water by EPA 200.8 (ICPMS)

Analyte	Sample Result	Detection Limit	Reporting Limit	Units	Dilution	Date Analyzed	Method Ref.	Notes
22821700-046CF23A (A3E1862-46)				Matrix: Drinking Water				
<u>Batch: 23F0465</u>								
Lead	2.55	---	0.200	ug/L	1	06/13/23 16:40	EPA 200.8	
22821700-047CF23A (A3E1862-47)				Matrix: Drinking Water				
<u>Batch: 23F0465</u>								
Lead	1.93	---	0.200	ug/L	1	06/13/23 16:41	EPA 200.8	
22821700-048SF23A (A3E1862-48)				Matrix: Drinking Water				
<u>Batch: 23F0465</u>								
Lead	0.578	---	0.200	ug/L	1	06/13/23 16:42	EPA 200.8	
22821700-049WB23A (A3E1862-49)				Matrix: Drinking Water				
<u>Batch: 23F0465</u>								
Lead	ND	---	0.200	ug/L	1	06/13/23 16:44	EPA 200.8	
22821700-050SF23A (A3E1862-50)				Matrix: Drinking Water				
<u>Batch: 23F0469</u>								
Lead	0.550	---	0.200	ug/L	1	06/13/23 16:50	EPA 200.8	
22821700-051BF23A (A3E1862-51)				Matrix: Drinking Water				
<u>Batch: 23F0469</u>								
Lead	0.705	---	0.200	ug/L	1	06/13/23 16:57	EPA 200.8	
22821700-052DW23A (A3E1862-52)				Matrix: Drinking Water				
<u>Batch: 23F0469</u>								
Lead	0.441	---	0.200	ug/L	1	06/13/23 16:58	EPA 200.8	
22821700-053CF23A (A3E1862-53)				Matrix: Drinking Water				
<u>Batch: 23F0469</u>								
Lead	0.695	---	0.200	ug/L	1	06/13/23 17:00	EPA 200.8	
22821700-054CF23A (A3E1862-54)				Matrix: Drinking Water				
<u>Batch: 23F0469</u>								
Lead	1.88	---	0.200	ug/L	1	06/13/23 17:01	EPA 200.8	
22821700-057BF23A (A3E1862-55)				Matrix: Drinking Water				

Apex Laboratories

Jason Woodcock, Project Manager

The results in this report apply to the samples analyzed in accordance with the chain of custody document. This analytical report must be reproduced in its entirety.



ANALYTICAL REPORT

Apex Laboratories, LLC

6700 S.W. Sandburg Street
Tigard, OR 97223
503-718-2323
ORELAP ID: OR100062

PBS Engineering and Environmental 4412 S Corbett Ave Portland, OR 97239	Project: Reynolds School District Project Number: Salish Ponds/23514.186 Project Manager: James Mastanduno	Report ID: A3E1862 - 06 16 23 1641
--	---	---

ANALYTICAL SAMPLE RESULTS

Total Metals in Drinking Water by EPA 200.8 (ICPMS)

Analyte	Sample Result	Detection Limit	Reporting Limit	Units	Dilution	Date Analyzed	Method Ref.	Notes
22821700-057BF23A (A3E1862-55)				Matrix: Drinking Water				
<u>Batch: 23F0469</u>								
Lead	1.15	---	0.200	ug/L	1	06/13/23 17:03	EPA 200.8	
22821700-058BF23A (A3E1862-56)				Matrix: Drinking Water				
<u>Batch: 23F0469</u>								
Lead	0.921	---	0.200	ug/L	1	06/13/23 17:04	EPA 200.8	
22821700-059BF23A (A3E1862-57)				Matrix: Drinking Water				
<u>Batch: 23F0469</u>								
Lead	0.635	---	0.200	ug/L	1	06/13/23 17:06	EPA 200.8	
22821700-060BF23A (A3E1862-58)				Matrix: Drinking Water				
<u>Batch: 23F0469</u>								
Lead	0.909	---	0.200	ug/L	1	06/13/23 17:07	EPA 200.8	
22821700-061WB23A (A3E1862-59)				Matrix: Drinking Water				
<u>Batch: 23F0469</u>								
Lead	ND	---	0.200	ug/L	1	06/13/23 17:08	EPA 200.8	
22821700-062DW23A (A3E1862-60)				Matrix: Drinking Water				
<u>Batch: 23F0469</u>								
Lead	ND	---	0.200	ug/L	1	06/13/23 17:10	EPA 200.8	
22821700-063BF23A (A3E1862-61RE1)				Matrix: Drinking Water				
<u>Batch: 23F0469</u>								
Lead	1.07	---	0.200	ug/L	1	06/13/23 18:43	EPA 200.8	
22821700-064BF23A (A3E1862-62RE1)				Matrix: Drinking Water				
<u>Batch: 23F0469</u>								
Lead	0.870	---	0.200	ug/L	1	06/13/23 18:45	EPA 200.8	
22821700-065BF23A (A3E1862-63RE1)				Matrix: Drinking Water				
<u>Batch: 23F0469</u>								
Lead	0.827	---	0.200	ug/L	1	06/13/23 18:46	EPA 200.8	
22821700-066BF23A (A3E1862-64RE1)				Matrix: Drinking Water				

Apex Laboratories

The results in this report apply to the samples analyzed in accordance with the chain of custody document. This analytical report must be reproduced in its entirety.

Jason Woodcock, Project Manager



ANALYTICAL REPORT

Apex Laboratories, LLC

6700 S.W. Sandburg Street
Tigard, OR 97223
503-718-2323
ORELAP ID: OR100062

PBS Engineering and Environmental 4412 S Corbett Ave Portland, OR 97239	Project: Reynolds School District Project Number: Salish Ponds/23514.186 Project Manager: James Mastanduno	Report ID: A3E1862 - 06 16 23 1641
--	---	---

ANALYTICAL SAMPLE RESULTS

Total Metals in Drinking Water by EPA 200.8 (ICPMS)

Analyte	Sample Result	Detection Limit	Reporting Limit	Units	Dilution	Date Analyzed	Method Ref.	Notes
22821700-066BF23A (A3E1862-64RE1)				Matrix: Drinking Water				
<u>Batch: 23F0469</u>								
Lead	0.292	---	0.200	ug/L	1	06/13/23 18:47	EPA 200.8	
22821700-067BF23A (A3E1862-65RE1)				Matrix: Drinking Water				
<u>Batch: 23F0469</u>								
Lead	1.42	---	0.200	ug/L	1	06/13/23 18:49	EPA 200.8	
22821700-068BF23A (A3E1862-66RE1)				Matrix: Drinking Water				
<u>Batch: 23F0469</u>								
Lead	1.34	---	0.200	ug/L	1	06/13/23 18:50	EPA 200.8	
22821700-069BF23A (A3E1862-67RE1)				Matrix: Drinking Water				
<u>Batch: 23F0469</u>								
Lead	1.23	---	0.200	ug/L	1	06/13/23 18:52	EPA 200.8	
22821700-070BF23A (A3E1862-68RE1)				Matrix: Drinking Water				
<u>Batch: 23F0469</u>								
Lead	0.570	---	0.200	ug/L	1	06/13/23 18:53	EPA 200.8	
22821700-071WB23A (A3E1862-69RE1)				Matrix: Drinking Water				
<u>Batch: 23F0469</u>								
Lead	ND	---	0.200	ug/L	1	06/13/23 18:55	EPA 200.8	
22821700-072DW23A (A3E1862-70RE1)				Matrix: Drinking Water				
<u>Batch: 23F0522</u>								
Lead	ND	---	0.200	ug/L	1	06/15/23 17:30	EPA 200.8	
22821700-073BF23A (A3E1862-71RE1)				Matrix: Drinking Water				
<u>Batch: 23F0522</u>								
Lead	2.57	---	0.200	ug/L	1	06/15/23 17:39	EPA 200.8	
22821700-074BF23A (A3E1862-72RE1)				Matrix: Drinking Water				
<u>Batch: 23F0522</u>								
Lead	2.12	---	0.200	ug/L	1	06/15/23 17:40	EPA 200.8	
22821700-075BF23A (A3E1862-73RE1)				Matrix: Drinking Water				

Apex Laboratories

The results in this report apply to the samples analyzed in accordance with the chain of custody document. This analytical report must be reproduced in its entirety.

Jason Woodcock, Project Manager



ANALYTICAL REPORT

Apex Laboratories, LLC

6700 S.W. Sandburg Street
Tigard, OR 97223
503-718-2323
ORELAP ID: OR100062

PBS Engineering and Environmental 4412 S Corbett Ave Portland, OR 97239	Project: Reynolds School District Project Number: Salish Ponds/23514.186 Project Manager: James Mastanduno	Report ID: A3E1862 - 06 16 23 1641
--	---	---

ANALYTICAL SAMPLE RESULTS

Total Metals in Drinking Water by EPA 200.8 (ICPMS)

Analyte	Sample Result	Detection Limit	Reporting Limit	Units	Dilution	Date Analyzed	Method Ref.	Notes
22821700-075BF23A (A3E1862-73RE1)				Matrix: Drinking Water				
<u>Batch: 23F0522</u>								
Lead	1.81	---	0.200	ug/L	1	06/15/23 17:41	EPA 200.8	
22821700-076BF23A (A3E1862-74RE1)				Matrix: Drinking Water				
<u>Batch: 23F0522</u>								
Lead	0.678	---	0.200	ug/L	1	06/15/23 17:43	EPA 200.8	
22821700-077CF23A (A3E1862-75RE1)				Matrix: Drinking Water				
<u>Batch: 23F0522</u>								
Lead	2.05	---	0.200	ug/L	1	06/15/23 17:44	EPA 200.8	
22821700-078CF23A (A3E1862-76)				Matrix: Drinking Water				
<u>Batch: 23F0522</u>								
Lead	0.954	---	0.200	ug/L	1	06/15/23 16:59	EPA 200.8	
22821700-079CF23A (A3E1862-77)				Matrix: Drinking Water				
<u>Batch: 23F0522</u>								
Lead	1.47	---	0.200	ug/L	1	06/15/23 17:01	EPA 200.8	
22821700-080CF23A (A3E1862-78)				Matrix: Drinking Water				
<u>Batch: 23F0522</u>								
Lead	5.61	---	0.200	ug/L	1	06/15/23 17:05	EPA 200.8	

Apex Laboratories

Jason Woodcock, Project Manager

The results in this report apply to the samples analyzed in accordance with the chain of custody document. This analytical report must be reproduced in its entirety.



ANALYTICAL REPORT

Apex Laboratories, LLC

6700 S.W. Sandburg Street
Tigard, OR 97223
503-718-2323
ORELAP ID: OR100062

<u>PBS Engineering and Environmental</u> 4412 S Corbett Ave Portland, OR 97239	Project: <u>Reynolds School District</u> Project Number: Salish Ponds/23514.186 Project Manager: James Mastanduno	Report ID: A3E1862 - 06 16 23 1641
---	--	---

QUALITY CONTROL (QC) SAMPLE RESULTS

Total Metals in Drinking Water by EPA 200.8 (ICPMS)

Analyte	Result	Detection Limit	Reporting Limit	Units	Dilution	Spike Amount	Source Result	% REC % REC	% REC Limits	RPD RPD	RPD Limit	Notes
Batch 23F0426 - EPA 3015A						Drinking Water						
Blank (23F0426-BLK1)		Prepared: 06/13/23 06:52		Analyzed: 06/13/23 23:56								
<u>EPA 200.8</u>												
Lead	ND	---	0.222	ug/L	1	---	---	---	---	---	---	
LCS (23F0426-BS1)		Prepared: 06/13/23 06:52		Analyzed: 06/14/23 00:01								
<u>EPA 200.8</u>												
Lead	17.7	---	0.222	ug/L	1	16.7	---	106	85 - 115%	---	---	
Batch 23F0444 - EPA 200.8 Direct Analysis						Drinking Water						
Blank (23F0444-BLK1)		Prepared: 06/13/23 09:08		Analyzed: 06/13/23 13:52								
<u>EPA 200.8</u>												
Lead	ND	---	0.200	ug/L	1	---	---	---	---	---	---	
LCS (23F0444-BS1)		Prepared: 06/13/23 09:08		Analyzed: 06/13/23 13:54								
<u>EPA 200.8</u>												
Lead	16.0	---	0.201	ug/L	1	15.0	---	107	85 - 115%	---	---	
Matrix Spike (23F0444-MS2)		Prepared: 06/13/23 09:08		Analyzed: 06/13/23 14:33								
<u>QC Source Sample: 22821700-009DW23A (A3E1862-09)</u>												
<u>EPA 200.8</u>												
Lead	14.9	---	0.201	ug/L	1	15.0	ND	99	70 - 130%	---	---	

Apex Laboratories

Jason Woodcock, Project Manager

The results in this report apply to the samples analyzed in accordance with the chain of custody document. This analytical report must be reproduced in its entirety.



ANALYTICAL REPORT

Apex Laboratories, LLC

6700 S.W. Sandburg Street
Tigard, OR 97223
503-718-2323
ORELAP ID: OR100062

PBS Engineering and Environmental 4412 S Corbett Ave Portland, OR 97239	Project: Reynolds School District Project Number: Salish Ponds/23514.186 Project Manager: James Mastanduno	Report ID: A3E1862 - 06 16 23 1641
--	---	---

QUALITY CONTROL (QC) SAMPLE RESULTS

Total Metals in Drinking Water by EPA 200.8 (ICPMS)

Analyte	Result	Detection Limit	Reporting Limit	Units	Dilution	Spike Amount	Source Result	% REC % REC	% REC Limits	RPD RPD	RPD Limit	Notes
Batch 23F0450 - EPA 200.8 Direct Analysis						Drinking Water						
Blank (23F0450-BLK1)		Prepared: 06/13/23 10:03 Analyzed: 06/13/23 14:37										
<u>EPA 200.8</u>												
Lead	ND	---	0.200	ug/L	1	---	---	---	---	---	---	---
LCS (23F0450-BS1)		Prepared: 06/13/23 10:03 Analyzed: 06/13/23 14:39										
<u>EPA 200.8</u>												
Lead	15.5	---	0.201	ug/L	1	15.0	---	103	85 - 115%	---	---	---
Duplicate (23F0450-DUP1)		Prepared: 06/13/23 10:03 Analyzed: 06/13/23 14:42										
<u>QC Source Sample: 22821700-010WB23A (A3E1862-10)</u>												
<u>EPA 200.8</u>												
Lead	ND	---	0.200	ug/L	1	---	0.103	---	---	***	20%	---
Matrix Spike (23F0450-MS1)		Prepared: 06/13/23 10:03 Analyzed: 06/13/23 14:43										
<u>QC Source Sample: 22821700-010WB23A (A3E1862-10)</u>												
<u>EPA 200.8</u>												
Lead	15.1	---	0.201	ug/L	1	15.0	0.103	100	70 - 130%	---	---	---
Matrix Spike (23F0450-MS2)		Prepared: 06/13/23 10:03 Analyzed: 06/13/23 15:18										
<u>QC Source Sample: 22821700-029WB23A (A3E1862-29)</u>												
<u>EPA 200.8</u>												
Lead	15.3	---	0.201	ug/L	1	15.0	ND	102	70 - 130%	---	---	---

Apex Laboratories

Jason Woodcock, Project Manager

The results in this report apply to the samples analyzed in accordance with the chain of custody document. This analytical report must be reproduced in its entirety.



ANALYTICAL REPORT

Apex Laboratories, LLC

6700 S.W. Sandburg Street
Tigard, OR 97223
503-718-2323
ORELAP ID: OR100062

PBS Engineering and Environmental 4412 S Corbett Ave Portland, OR 97239	Project: Reynolds School District Project Number: Salish Ponds/23514.186 Project Manager: James Mastanduno	Report ID: A3E1862 - 06 16 23 1641
--	---	---

QUALITY CONTROL (QC) SAMPLE RESULTS

Total Metals in Drinking Water by EPA 200.8 (ICPMS)

Analyte	Result	Detection Limit	Reporting Limit	Units	Dilution	Spike Amount	Source Result	% REC % REC	% REC Limits	RPD RPD	RPD Limit	Notes
Batch 23F0465 - EPA 200.8 Direct Analysis						Drinking Water						
Blank (23F0465-BLK1)		Prepared: 06/13/23 14:18 Analyzed: 06/13/23 16:02										
<u>EPA 200.8</u>												
Lead	ND	---	0.200	ug/L	1	---	---	---	---	---	---	---
LCS (23F0465-BS1)		Prepared: 06/13/23 14:18 Analyzed: 06/13/23 16:04										
<u>EPA 200.8</u>												
Lead	15.4	---	0.201	ug/L	1	15.0	---	103	85 - 115%	---	---	---
Duplicate (23F0465-DUP1)		Prepared: 06/13/23 14:18 Analyzed: 06/13/23 16:07										
<u>QC Source Sample: 22821700-030CF23A (A3E1862-30)</u>												
<u>EPA 200.8</u>												
Lead	1.89	---	0.200	ug/L	1	---	1.91	---	---	0.8	20%	---
Matrix Spike (23F0465-MS1)		Prepared: 06/13/23 14:18 Analyzed: 06/13/23 16:09										
<u>QC Source Sample: 22821700-030CF23A (A3E1862-30)</u>												
<u>EPA 200.8</u>												
Lead	16.9	---	0.201	ug/L	1	15.0	1.91	100	70 - 130%	---	---	---
Matrix Spike (23F0465-MS2)		Prepared: 06/13/23 14:18 Analyzed: 06/13/23 16:45										
<u>QC Source Sample: 22821700-049WB23A (A3E1862-49)</u>												
<u>EPA 200.8</u>												
Lead	14.4	---	0.201	ug/L	1	15.0	ND	96	70 - 130%	---	---	---

Apex Laboratories

Jason Woodcock, Project Manager

The results in this report apply to the samples analyzed in accordance with the chain of custody document. This analytical report must be reproduced in its entirety.



ANALYTICAL REPORT

Apex Laboratories, LLC

6700 S.W. Sandburg Street
Tigard, OR 97223
503-718-2323
ORELAP ID: OR100062

PBS Engineering and Environmental 4412 S Corbett Ave Portland, OR 97239	Project: Reynolds School District Project Number: Salish Ponds/23514.186 Project Manager: James Mastanduno	Report ID: A3E1862 - 06 16 23 1641
--	---	---

QUALITY CONTROL (QC) SAMPLE RESULTS

Total Metals in Drinking Water by EPA 200.8 (ICPMS)

Analyte	Result	Detection Limit	Reporting Limit	Units	Dilution	Spike Amount	Source Result	% REC % REC	% REC Limits	RPD RPD	RPD Limit	Notes
Batch 23F0469 - EPA 200.8 Direct Analysis						Drinking Water						
Blank (23F0469-BLK1)		Prepared: 06/13/23 15:17 Analyzed: 06/13/23 16:47										
<u>EPA 200.8</u>												
Lead	ND	---	0.200	ug/L	1	---	---	---	---	---	---	---
LCS (23F0469-BS1)		Prepared: 06/13/23 15:17 Analyzed: 06/13/23 16:48										
<u>EPA 200.8</u>												
Lead	15.6	---	0.201	ug/L	1	15.0	---	104	85 - 115%	---	---	---
Duplicate (23F0469-DUP1)		Prepared: 06/13/23 15:17 Analyzed: 06/13/23 16:51										
<u>QC Source Sample: 22821700-050SF23A (A3E1862-50)</u>												
<u>EPA 200.8</u>												
Lead	0.550	---	0.200	ug/L	1	---	0.550	---	---	0.01	20%	---
Matrix Spike (23F0469-MS1)		Prepared: 06/13/23 15:17 Analyzed: 06/13/23 16:53										
<u>QC Source Sample: 22821700-050SF23A (A3E1862-50)</u>												
<u>EPA 200.8</u>												
Lead	15.2	---	0.201	ug/L	1	15.0	0.550	98	70 - 130%	---	---	---
Matrix Spike (23F0469-MS3)		Prepared: 06/13/23 15:17 Analyzed: 06/13/23 18:56										
<u>QC Source Sample: 22821700-071WB23A (A3E1862-69RE1)</u>												
<u>EPA 200.8</u>												
Lead	14.0	---	0.201	ug/L	1	15.0	ND	93	70 - 130%	---	---	Q-16

Apex Laboratories

Jason Woodcock, Project Manager

The results in this report apply to the samples analyzed in accordance with the chain of custody document. This analytical report must be reproduced in its entirety.



ANALYTICAL REPORT

Apex Laboratories, LLC

6700 S.W. Sandburg Street
Tigard, OR 97223
503-718-2323
ORELAP ID: OR100062

PBS Engineering and Environmental 4412 S Corbett Ave Portland, OR 97239	Project: Reynolds School District Project Number: Salish Ponds/23514.186 Project Manager: James Mastanduno	Report ID: A3E1862 - 06 16 23 1641
--	---	---

QUALITY CONTROL (QC) SAMPLE RESULTS

Total Metals in Drinking Water by EPA 200.8 (ICPMS)

Analyte	Result	Detection Limit	Reporting Limit	Units	Dilution	Spike Amount	Source Result	% REC % REC	% REC Limits	RPD RPD	RPD Limit	Notes
Batch 23F0522 - EPA 200.8 Direct Analysis						Drinking Water						
Blank (23F0522-BLK2)		Prepared: 06/14/23 15:35 Analyzed: 06/15/23 17:27										
<u>EPA 200.8</u>												
Lead	ND	---	0.200	ug/L	1	---	---	---	---	---	---	Q-16
LCS (23F0522-BS2)		Prepared: 06/14/23 15:35 Analyzed: 06/15/23 17:28										
<u>EPA 200.8</u>												
Lead	14.6	---	0.201	ug/L	1	15.0	---	98	85 - 115%	---	---	Q-16
Duplicate (23F0522-DUP2)		Prepared: 06/14/23 15:35 Analyzed: 06/15/23 17:31										
<u>QC Source Sample: 22821700-072DW23A (A3E1862-70RE1)</u>												
<u>EPA 200.8</u>												
Lead	ND	---	0.200	ug/L	1	---	ND	---	---	---	20%	Q-16
Matrix Spike (23F0522-MS3)		Prepared: 06/14/23 15:35 Analyzed: 06/15/23 17:33										
<u>QC Source Sample: 22821700-072DW23A (A3E1862-70RE1)</u>												
<u>EPA 200.8</u>												
Lead	14.7	---	0.201	ug/L	1	15.0	ND	98	70 - 130%	---	---	Q-16

Apex Laboratories

Jason Woodcock, Project Manager

The results in this report apply to the samples analyzed in accordance with the chain of custody document. This analytical report must be reproduced in its entirety.



ANALYTICAL REPORT

Apex Laboratories, LLC

6700 S.W. Sandburg Street
Tigard, OR 97223
503-718-2323

ORELAP ID: OR100062

PBS Engineering and Environmental 4412 S Corbett Ave Portland, OR 97239	Project: Reynolds School District Project Number: Salish Ponds/23514.186 Project Manager: James Mastanduno	Report ID: A3E1862 - 06 16 23 1641
--	---	---

SAMPLE PREPARATION INFORMATION

Total Metals in Drinking Water by EPA 200.8 (ICPMS)

Prep: EPA 200.8 Direct Analysis

Lab Number	Matrix	Method	Sampled	Prepared	Sample Initial/Final	Default Initial/Final	RL Prep Factor
<u>Batch: 23F0444</u>							
A3E1862-01	Drinking Water	EPA 200.8	05/25/23 00:00	06/13/23 09:08	10mL/10mL	10mL/10mL	1.00
A3E1862-04	Drinking Water	EPA 200.8	05/25/23 00:00	06/13/23 09:08	10mL/10mL	10mL/10mL	1.00
A3E1862-05	Drinking Water	EPA 200.8	05/25/23 00:00	06/13/23 09:08	10mL/10mL	10mL/10mL	1.00
A3E1862-06	Drinking Water	EPA 200.8	05/25/23 00:00	06/13/23 09:08	10mL/10mL	10mL/10mL	1.00
A3E1862-07	Drinking Water	EPA 200.8	05/25/23 00:00	06/13/23 09:08	10mL/10mL	10mL/10mL	1.00
A3E1862-08	Drinking Water	EPA 200.8	05/25/23 00:00	06/13/23 09:08	10mL/10mL	10mL/10mL	1.00
A3E1862-09	Drinking Water	EPA 200.8	05/25/23 00:00	06/13/23 09:08	10mL/10mL	10mL/10mL	1.00
<u>Batch: 23F0450</u>							
A3E1862-10	Drinking Water	EPA 200.8	05/25/23 00:00	06/13/23 10:03	10mL/10mL	10mL/10mL	1.00
A3E1862-11	Drinking Water	EPA 200.8	05/25/23 00:00	06/13/23 10:03	10mL/10mL	10mL/10mL	1.00
A3E1862-12	Drinking Water	EPA 200.8	05/25/23 00:00	06/13/23 10:03	10mL/10mL	10mL/10mL	1.00
A3E1862-13	Drinking Water	EPA 200.8	05/25/23 00:00	06/13/23 10:03	10mL/10mL	10mL/10mL	1.00
A3E1862-14	Drinking Water	EPA 200.8	05/25/23 00:00	06/13/23 10:03	10mL/10mL	10mL/10mL	1.00
A3E1862-15	Drinking Water	EPA 200.8	05/25/23 00:00	06/13/23 10:03	10mL/10mL	10mL/10mL	1.00
A3E1862-16	Drinking Water	EPA 200.8	05/25/23 00:00	06/13/23 10:03	10mL/10mL	10mL/10mL	1.00
A3E1862-17	Drinking Water	EPA 200.8	05/25/23 00:00	06/13/23 10:03	10mL/10mL	10mL/10mL	1.00
A3E1862-18	Drinking Water	EPA 200.8	05/25/23 00:00	06/13/23 10:03	10mL/10mL	10mL/10mL	1.00
A3E1862-19	Drinking Water	EPA 200.8	05/25/23 00:00	06/13/23 10:03	10mL/10mL	10mL/10mL	1.00
A3E1862-20	Drinking Water	EPA 200.8	05/25/23 00:00	06/13/23 10:03	10mL/10mL	10mL/10mL	1.00
A3E1862-21	Drinking Water	EPA 200.8	05/25/23 00:00	06/13/23 10:03	10mL/10mL	10mL/10mL	1.00
A3E1862-22	Drinking Water	EPA 200.8	05/25/23 00:00	06/13/23 10:03	10mL/10mL	10mL/10mL	1.00
A3E1862-23	Drinking Water	EPA 200.8	05/25/23 00:00	06/13/23 10:03	10mL/10mL	10mL/10mL	1.00
A3E1862-24	Drinking Water	EPA 200.8	05/25/23 00:00	06/13/23 10:03	10mL/10mL	10mL/10mL	1.00
A3E1862-25	Drinking Water	EPA 200.8	05/25/23 00:00	06/13/23 10:03	10mL/10mL	10mL/10mL	1.00
A3E1862-26	Drinking Water	EPA 200.8	05/25/23 00:00	06/13/23 10:03	10mL/10mL	10mL/10mL	1.00
A3E1862-27	Drinking Water	EPA 200.8	05/25/23 00:00	06/13/23 10:03	10mL/10mL	10mL/10mL	1.00
A3E1862-28	Drinking Water	EPA 200.8	05/25/23 00:00	06/13/23 10:03	10mL/10mL	10mL/10mL	1.00
A3E1862-29	Drinking Water	EPA 200.8	05/25/23 00:00	06/13/23 10:03	10mL/10mL	10mL/10mL	1.00
<u>Batch: 23F0465</u>							
A3E1862-30	Drinking Water	EPA 200.8	05/25/23 00:00	06/13/23 14:18	10mL/10mL	10mL/10mL	1.00
A3E1862-31	Drinking Water	EPA 200.8	05/25/23 00:00	06/13/23 14:18	10mL/10mL	10mL/10mL	1.00
A3E1862-32	Drinking Water	EPA 200.8	05/25/23 00:00	06/13/23 14:18	10mL/10mL	10mL/10mL	1.00
A3E1862-33	Drinking Water	EPA 200.8	05/25/23 00:00	06/13/23 14:18	10mL/10mL	10mL/10mL	1.00
A3E1862-34	Drinking Water	EPA 200.8	05/25/23 00:00	06/13/23 14:18	10mL/10mL	10mL/10mL	1.00
A3E1862-35	Drinking Water	EPA 200.8	05/25/23 00:00	06/13/23 14:18	10mL/10mL	10mL/10mL	1.00

Apex Laboratories

The results in this report apply to the samples analyzed in accordance with the chain of custody document. This analytical report must be reproduced in its entirety.

Jason Woodcock, Project Manager



ANALYTICAL REPORT

Apex Laboratories, LLC

6700 S.W. Sandburg Street
Tigard, OR 97223
503-718-2323

ORELAP ID: OR100062

<u>PBS Engineering and Environmental</u> 4412 S Corbett Ave Portland, OR 97239	Project: <u>Reynolds School District</u> Project Number: Salish Ponds/23514.186 Project Manager: James Mastanduno	Report ID: A3E1862 - 06 16 23 1641
---	--	--

SAMPLE PREPARATION INFORMATION

Total Metals in Drinking Water by EPA 200.8 (ICPMS)

Prep: EPA 200.8 Direct Analysis

Lab Number	Matrix	Method	Sampled	Prepared	Sample Initial/Final	Default Initial/Final	RL Prep Factor
A3E1862-36	Drinking Water	EPA 200.8	05/25/23 00:00	06/13/23 14:18	10mL/10mL	10mL/10mL	1.00
A3E1862-37	Drinking Water	EPA 200.8	05/25/23 00:00	06/13/23 14:18	10mL/10mL	10mL/10mL	1.00
A3E1862-38	Drinking Water	EPA 200.8	05/25/23 00:00	06/13/23 14:18	10mL/10mL	10mL/10mL	1.00
A3E1862-39	Drinking Water	EPA 200.8	05/25/23 00:00	06/13/23 14:18	10mL/10mL	10mL/10mL	1.00
A3E1862-40	Drinking Water	EPA 200.8	05/25/23 00:00	06/13/23 14:18	10mL/10mL	10mL/10mL	1.00
A3E1862-41	Drinking Water	EPA 200.8	05/25/23 00:00	06/13/23 14:18	10mL/10mL	10mL/10mL	1.00
A3E1862-42	Drinking Water	EPA 200.8	05/25/23 00:00	06/13/23 14:18	10mL/10mL	10mL/10mL	1.00
A3E1862-43	Drinking Water	EPA 200.8	05/25/23 00:00	06/13/23 14:18	10mL/10mL	10mL/10mL	1.00
A3E1862-44	Drinking Water	EPA 200.8	05/25/23 00:00	06/13/23 14:18	10mL/10mL	10mL/10mL	1.00
A3E1862-45	Drinking Water	EPA 200.8	05/25/23 00:00	06/13/23 14:18	10mL/10mL	10mL/10mL	1.00
A3E1862-46	Drinking Water	EPA 200.8	05/25/23 00:00	06/13/23 14:18	10mL/10mL	10mL/10mL	1.00
A3E1862-47	Drinking Water	EPA 200.8	05/25/23 00:00	06/13/23 14:18	10mL/10mL	10mL/10mL	1.00
A3E1862-48	Drinking Water	EPA 200.8	05/25/23 00:00	06/13/23 14:18	10mL/10mL	10mL/10mL	1.00
A3E1862-49	Drinking Water	EPA 200.8	05/25/23 00:00	06/13/23 14:18	10mL/10mL	10mL/10mL	1.00

Batch: 23F0469

A3E1862-50	Drinking Water	EPA 200.8	05/25/23 00:00	06/13/23 15:17	10mL/10mL	10mL/10mL	1.00
A3E1862-51	Drinking Water	EPA 200.8	05/25/23 00:00	06/13/23 15:17	10mL/10mL	10mL/10mL	1.00
A3E1862-52	Drinking Water	EPA 200.8	05/25/23 00:00	06/13/23 15:17	10mL/10mL	10mL/10mL	1.00
A3E1862-53	Drinking Water	EPA 200.8	05/25/23 00:00	06/13/23 15:17	10mL/10mL	10mL/10mL	1.00
A3E1862-54	Drinking Water	EPA 200.8	05/25/23 00:00	06/13/23 15:17	10mL/10mL	10mL/10mL	1.00
A3E1862-55	Drinking Water	EPA 200.8	05/25/23 00:00	06/13/23 15:17	10mL/10mL	10mL/10mL	1.00
A3E1862-56	Drinking Water	EPA 200.8	05/25/23 00:00	06/13/23 15:17	10mL/10mL	10mL/10mL	1.00
A3E1862-57	Drinking Water	EPA 200.8	05/25/23 00:00	06/13/23 15:17	10mL/10mL	10mL/10mL	1.00
A3E1862-58	Drinking Water	EPA 200.8	05/25/23 00:00	06/13/23 15:17	10mL/10mL	10mL/10mL	1.00
A3E1862-59	Drinking Water	EPA 200.8	05/25/23 00:00	06/13/23 15:17	10mL/10mL	10mL/10mL	1.00
A3E1862-60	Drinking Water	EPA 200.8	05/25/23 00:00	06/13/23 15:17	10mL/10mL	10mL/10mL	1.00
A3E1862-61RE1	Drinking Water	EPA 200.8	05/25/23 00:00	06/13/23 15:17	10mL/10mL	10mL/10mL	1.00
A3E1862-62RE1	Drinking Water	EPA 200.8	05/25/23 00:00	06/13/23 15:17	10mL/10mL	10mL/10mL	1.00
A3E1862-63RE1	Drinking Water	EPA 200.8	05/25/23 00:00	06/13/23 15:17	10mL/10mL	10mL/10mL	1.00
A3E1862-64RE1	Drinking Water	EPA 200.8	05/25/23 00:00	06/13/23 15:17	10mL/10mL	10mL/10mL	1.00
A3E1862-65RE1	Drinking Water	EPA 200.8	05/25/23 00:00	06/13/23 15:17	10mL/10mL	10mL/10mL	1.00
A3E1862-66RE1	Drinking Water	EPA 200.8	05/25/23 00:00	06/13/23 15:17	10mL/10mL	10mL/10mL	1.00
A3E1862-67RE1	Drinking Water	EPA 200.8	05/25/23 00:00	06/13/23 15:17	10mL/10mL	10mL/10mL	1.00
A3E1862-68RE1	Drinking Water	EPA 200.8	05/25/23 00:00	06/13/23 15:17	10mL/10mL	10mL/10mL	1.00
A3E1862-69RE1	Drinking Water	EPA 200.8	05/25/23 00:00	06/13/23 15:17	10mL/10mL	10mL/10mL	1.00

Batch: 23F0522

Apex Laboratories

The results in this report apply to the samples analyzed in accordance with the chain of custody document. This analytical report must be reproduced in its entirety.

Jason Woodcock, Project Manager



ANALYTICAL REPORT

Apex Laboratories, LLC

6700 S.W. Sandburg Street
Tigard, OR 97223
503-718-2323
ORELAP ID: OR100062

<u>PBS Engineering and Environmental</u> 4412 S Corbett Ave Portland, OR 97239	Project: <u>Reynolds School District</u> Project Number: Salish Ponds/23514.186 Project Manager: James Mastanduno	Report ID: A3E1862 - 06 16 23 1641
---	--	---

SAMPLE PREPARATION INFORMATION

Total Metals in Drinking Water by EPA 200.8 (ICPMS)

Prep: EPA 200.8 Direct Analysis

Lab Number	Matrix	Method	Sampled	Prepared	Sample Initial/Final	Default Initial/Final	RL Prep Factor
A3E1862-70RE1	Drinking Water	EPA 200.8	05/25/23 00:00	06/14/23 15:35	10mL/10mL	10mL/10mL	1.00
A3E1862-71RE1	Drinking Water	EPA 200.8	05/25/23 00:00	06/14/23 15:35	10mL/10mL	10mL/10mL	1.00
A3E1862-72RE1	Drinking Water	EPA 200.8	05/25/23 00:00	06/14/23 15:35	10mL/10mL	10mL/10mL	1.00
A3E1862-73RE1	Drinking Water	EPA 200.8	05/25/23 00:00	06/14/23 15:35	10mL/10mL	10mL/10mL	1.00
A3E1862-74RE1	Drinking Water	EPA 200.8	05/25/23 00:00	06/14/23 15:35	10mL/10mL	10mL/10mL	1.00
A3E1862-75RE1	Drinking Water	EPA 200.8	05/25/23 00:00	06/14/23 15:35	10mL/10mL	10mL/10mL	1.00
A3E1862-76	Drinking Water	EPA 200.8	05/25/23 00:00	06/14/23 15:35	10mL/10mL	10mL/10mL	1.00
A3E1862-77	Drinking Water	EPA 200.8	05/25/23 00:00	06/14/23 15:35	10mL/10mL	10mL/10mL	1.00
A3E1862-78	Drinking Water	EPA 200.8	05/25/23 00:00	06/14/23 15:35	10mL/10mL	10mL/10mL	1.00

Prep: EPA 3015A

Lab Number	Matrix	Method	Sampled	Prepared	Sample Initial/Final	Default Initial/Final	RL Prep Factor
<u>Batch: 23F0426</u>							
A3E1862-02	Drinking Water	EPA 200.8	05/25/23 00:00	06/13/23 06:52	45mL/50mL	10mL/10mL	1.11
A3E1862-03	Drinking Water	EPA 200.8	05/25/23 00:00	06/13/23 06:52	45mL/50mL	10mL/10mL	1.11

Apex Laboratories

The results in this report apply to the samples analyzed in accordance with the chain of custody document. This analytical report must be reproduced in its entirety.

Jason Woodcock, Project Manager



ANALYTICAL REPORT

Apex Laboratories, LLC
6700 S.W. Sandburg Street
Tigard, OR 97223
503-718-2323
ORELAP ID: OR100062

PBS Engineering and Environmental 4412 S Corbett Ave Portland, OR 97239	Project: Reynolds School District Project Number: Salish Ponds/23514.186 Project Manager: James Mastanduno	Report ID: A3E1862 - 06 16 23 1641
--	---	--

QUALIFIER DEFINITIONS

Client Sample and Quality Control (QC) Sample Qualifier Definitions:

Apex Laboratories

- DW-D** Turbidity greater than 1 NTU. Sample was digested per EPA Method 200.8.
- Q-16** Reanalysis of an original Batch QC sample.

Apex Laboratories

The results in this report apply to the samples analyzed in accordance with the chain of custody document. This analytical report must be reproduced in its entirety.

Jason Woodcock, Project Manager



ANALYTICAL REPORT

Apex Laboratories, LLC

6700 S.W. Sandburg Street
Tigard, OR 97223
503-718-2323
ORELAP ID: OR100062

<u>PBS Engineering and Environmental</u> 4412 S Corbett Ave Portland, OR 97239	Project: <u>Reynolds School District</u> Project Number: Salish Ponds/23514.186 Project Manager: James Mastanduno	Report ID: A3E1862 - 06 16 23 1641
---	--	---

REPORTING NOTES AND CONVENTIONS:

Abbreviations:

- DET Analyte DETECTED at or above the detection or reporting limit.
- ND Analyte NOT DETECTED at or above the detection or reporting limit.
- NR Result Not Reported.
- RPD Relative Percent Difference. RPDs for Matrix Spikes and Matrix Spike Duplicates are based on concentration, not recovery.

Detection Limits: Limit of Detection (LOD)

Limits of Detection (LODs) are normally set at a level of one half the validated Limit of Quantitation (LOQ).
If no value is listed ('----'), then the data has not been evaluated below the Reporting Limit.

Reporting Limits: Limit of Quantitation (LOQ)

Validated Limits of Quantitation (LOQs) are reported as the Reporting Limits for all analyses where the LOQ, MRL, PQL or CRL are requested. The LOQ represents a level at or above the low point of the calibration curve, that has been validated according to Apex Laboratories' comprehensive LOQ policies and procedures.

Reporting Conventions:

- Basis: Results for soil samples are generally reported on a 100% dry weight basis.
The Result Basis is listed following the units as " dry", " wet", or " " (blank) designation.
- " dry" Sample results and Reporting Limits are reported on a dry weight basis. (i.e. "ug/kg dry")
See Percent Solids section for details of dry weight analysis.
- " wet" Sample results and Reporting Limits for this analysis are normally dry weight corrected, but have not been modified in this case.
- " " Results without 'wet' or 'dry' designation are not normally dry weight corrected. These results are considered 'As Received'.

QC Source:

In cases where there is insufficient sample provided for Sample Duplicates and/or Matrix Spikes, a Lab Control Sample Duplicate (LCS Dup) may be analyzed to demonstrate accuracy and precision of the extraction batch.

Non-Client Batch QC Samples (Duplicates and Matrix Spike/Duplicates) are not included in this report. Please request a Full QC report if this data is required.

Miscellaneous Notes:

- " --- " QC results are not applicable. For example, % Recoveries for Blanks and Duplicates, % RPD for Blanks, Blank Spikes and Matrix Spikes, etc.
- " *** " Used to indicate a possible discrepancy with the Sample and Sample Duplicate results when the %RPD is not available. In this case, either the Sample or the Sample Duplicate has a reportable result for this analyte, while the other is Non Detect (ND).

Blanks:

Standard practice is to evaluate the results from Blank QC Samples down to a level equal to ½ the Reporting Limit (RL).
-For Blank hits falling between ½ the RL and the RL (J flagged hits), the associated sample and QC data will receive a 'B-02' qualifier.
-For Blank hits above the RL, the associated sample and QC data will receive a 'B' qualifier, per Apex Laboratories' Blank Policy.
For further details, please request a copy of this document.

Apex Laboratories

The results in this report apply to the samples analyzed in accordance with the chain of custody document. This analytical report must be reproduced in its entirety.

Jason Woodcock, Project Manager



ANALYTICAL REPORT

Apex Laboratories, LLC

6700 S.W. Sandburg Street
Tigard, OR 97223
503-718-2323
ORELAP ID: OR100062

<u>PBS Engineering and Environmental</u> 4412 S Corbett Ave Portland, OR 97239	Project: <u>Reynolds School District</u> Project Number: Salish Ponds/23514.186 Project Manager: James Mastanduno	Report ID: A3E1862 - 06 16 23 1641
---	--	---

REPORTING NOTES AND CONVENTIONS (Cont.):

Blanks (Cont.):

Sample results flagged with a 'B' or 'B-02' qualifier are potentially biased high if the sample results are less than ten times the level found in the blank for inorganic analyses, or less than five times the level found in the blank for organic analyses.

'B' and 'B-02' qualifications are only applied to sample results detected above the Reporting Level.

Preparation Notes:

Mixed Matrix Samples:

Water Samples:

Water samples containing significant amounts of sediment are decanted or separated prior to extraction, and only the water portion analyzed, unless otherwise directed by the client.

Soil and Sediment Samples:

Soil and Sediment samples containing significant amounts of water are decanted prior to extraction, and only the solid portion analyzed, unless otherwise directed by the client.

Sampling and Preservation Notes:

Certain regulatory programs, such as National Pollutant Discharge Elimination System (NPDES), require that activities such as sample filtration (for dissolved metals, orthophosphate, hexavalent chromium, etc.) and testing of short hold analytes (pH, Dissolved Oxygen, etc.) be performed in the field (on-site) within a short time window. In addition, sample matrix spikes are required for some analyses, and sufficient volume must be provided, and billable site specific QC requested, if this is required. All regulatory permits should be reviewed to ensure that these requirements are being met.

Data users should be aware of which regulations pertain to the samples they submit for testing. If related sample collection activities are not approved for a particular regulatory program, results should be considered estimates. Apex Laboratories will qualify these analytes according to the most stringent requirements, however results for samples that are for non-regulatory purposes may be acceptable.

Samples that have been filtered and preserved at Apex Laboratories per client request are listed in the preparation section of the report with the date and time of filtration listed.

Apex Laboratories maintains detailed records on sample receipt, including client label verification, cooler temperature, sample preservation, hold time compliance and field filtration. Data is qualified as necessary, and the lack of qualification indicates compliance with required parameters.

Apex Laboratories

The results in this report apply to the samples analyzed in accordance with the chain of custody document. This analytical report must be reproduced in its entirety.

Jason Woodcock, Project Manager



ANALYTICAL REPORT

Apex Laboratories, LLC

6700 S.W. Sandburg Street
Tigard, OR 97223
503-718-2323
ORELAP ID: OR100062

Table with 3 columns: Client (PBS Engineering and Environmental), Project (Reynolds School District), and Report ID (A3E1862 - 06 16 23 1641).

LABORATORY ACCREDITATION INFORMATION

ORELAP Certification ID: OR100062 (Primary Accreditation)
EPA ID: OR01039

All methods and analytes reported from work performed at Apex Laboratories are included on Apex Laboratories' ORELAP Scope of Certification, with the exception of any analyte(s) listed below:

Apex Laboratories

Table header with columns: Matrix, Analysis, TNI_ID, Analyte, TNI_ID, Accreditation

All reported analytes are included in Apex Laboratories' current ORELAP scope.

Secondary Accreditations

Apex Laboratories also maintains reciprocal accreditation with non-TNI states (Washington DOE), as well as other state specific accreditations not listed here.

Subcontract Laboratory Accreditations

Subcontracted data falls outside of Apex Laboratories' Scope of Accreditation. Please see the Subcontract Laboratory report for full details, or contact your Project Manager for more information.

Field Testing Parameters

Results for Field Tested data are provided by the client or sampler, and fall outside of Apex Laboratories' Scope of Accreditation.

Apex Laboratories

Handwritten signature of Jason Woodcock

The results in this report apply to the samples analyzed in accordance with the chain of custody document. This analytical report must be reproduced in its entirety.

Jason Woodcock, Project Manager



ANALYTICAL REPORT

Apex Laboratories, LLC

6700 S.W. Sandburg Street
 Tigard, OR 97223
 503-718-2323
 ORELAP ID: OR100062

PBS Engineering and Environmental
 4412 S Corbett Ave
 Portland, OR 97239

Project: **Reynolds School District**
 Project Number: **Salish Ponds/23514.186**
 Project Manager: **James Mastanduno**

Report ID:
A3E1862 - 06 16 23 1641

A3E1862

Lead in Drinking Water Testing Program		Reynolds School District	
Date Collected:	5-25-23	PBS Project:	23514.186
School Name:	Salish Ponds	Building Number:	22821700
Analysis Requested:	Lead (Pb) in drinking water		
Relinquished By:	Seirendun/Kindrick	Date/Time:	06/20/23/12:00PM
Received By:	James Mastanduno	Date/Time:	5/30/23 12:40
Email Results to:	james.mastanduno@pbsusa.com	Turnaround Time:	10 - Day

Fixture Number	Sample Number	Room/Location
001 SE	22821700-001SE3A	Kitchen, Food staff hand washing station
002 KF	22821700-002KF3A	Kitchen, SE Food prep sinks (east)
003 KF	22821700-003KF3A	Kitchen, SE Food prep sinks (west)
004 KF	22821700-004KF3A	Kitchen, dishwashing sink
005 KF	22821700-005KF3A	Kitchen, south wash sink
006 SF	22821700-006SF3A	Kitchen Restroom South Bathroom sink
007 BF	22821700-007BF3A	Cafeteria, West Bathroom sink
008 BF	22821700-008BF3A	Cafeteria, South Bathroom sink
009 DW (L)	22821700-009DW3A	Cafeteria, South Drinking Fountain Left
010 WB	22821700-010WB3A	Cafeteria, South Drinking Bottle Fill
011 DW (R)	22821700-011DW3A	Cafeteria, South Drinking Fountain Right
012 BF	22821700-012BF3A	Girls RR, South hallway, South sink
013 BF	22821700-013BF3A	Center sink
014 BF	22821700-014BF3A	North sink
015 BF	22821700-015BF3A	RR, South hallway, left sink
016 BF	22821700-016BF3A	RR, South hallway, right sink
017 CF	22821700-017CF3A	Rm 9, classroom sink
018 CF	22821700-018CF3A	Rm 11, classroom sink
019 DW	22821700-019DW3A	Drinking fountain, hallway near Rm 11
020 WB	22821700-020WB3A	water fill station, hallway near Rm 11
021 CF	22821700-021CF3A	Rm 13, classroom sink
022 CF	22821700-022CF3A	Rm 15, classroom sink
023 CF	22821700-023CF3A	Rm 14, classroom sink
024 CF	22821700-024CF3A	Rm 12, classroom sink
025 CF	22821700-025CF3A	Rm 10, classroom sink
026 CF	22821700-026CF3A	Rm 7, classroom sink
027 CF	22821700-027CF3A	Rm 4, classroom sink
028 DW	22821700-028DW3A	Hallway drinking fountain near Rm 4
029 WB	22821700-029WB3A	Hallway water fill station near Rm 4
030 CF	22821700-030CF3A	Rm 6, classroom sink
031 CF	22821700-031CF3A	Rm 7, classroom sink
032 CF	22821700-032CF3A	Rm 5, classroom sink
033 CF	22821700-033CF3A	Rm 3, classroom sink
034 CF	22821700-034CF3A	Rm 1, classroom sink
035 OT	22821700-035OT3A	utility sink in hallway in commons hallway
036 BF	22821700-036BF3A	Girls RR, Commons hallway; north sink
037 BF	22821700-037BF3A	" " center sink
038 BF	22821700-038BF3A	" " south sink

Apex Laboratories

The results in this report apply to the samples analyzed in accordance with the chain of custody document. This analytical report must be reproduced in its entirety.

Jason Woodcock, Project Manager

PBS Engineering and Environmental	Project: Reynolds School District	
4412 S Corbett Ave	Project Number: Salish Ponds/23514.186	Report ID:
Portland, OR 97239	Project Manager: James Mastanduno	A3E1862 - 06 16 23 1641

A3E1862

Lead in Drinking Water Testing Program		Reynolds School District	
Date Collected:	05/25/23	PBS Project:	23514.186
School Name:	Salish Ponds	Building Number:	22825700
Analysis Requested:	Lead (Pb) in drinking water		
Relinquished By:	Seirendy A. Hendrix	Date/Time:	05/30/23 / 12:00 PM
Received By:	James Mastanduno	Date/Time:	5/30/23 12:40
Email Results to:	james.mastanduno@pbsusa.com	Turnaround Time:	10 - Day

Fixture Number	Sample Number	Room/Location
039 DW	22821700-039DW23A	Courtesy Hallway, North Drinking Fountain
040 WB	22821700-040WB23A	Courtesy Hallway, North Fill Station
041 BF	22821700-041BF23A	Boys RR, Common Hallway, North Sink
042 BF	22821700-042BF23A	" " " " " " " " " " " "
043 BF	22821700-043BF23A	" " " " " " " " " " " "
044 WB	22821700-044WB23A	Main Office, Water Bottle Fill
045 NS	22821700-045NS23A	Men's office, RR, Sink
046 CF	22821700-046CF23A	Room 19, Classroom Sink
047 CF	22821700-047CF23A	Room 19, Classroom Sink
048 SF	22821700-048SF23A	Teachers lounge, Sink
049 WB	22821700-049WB23A	" " " " " " " " " " " "
050 SF	22821700-050SF23A	Teachers lounge, RR, Sink
051 BF	22821700-051BF23A	Room 19, Bathroom Sink
052 DW	22821700-052DW23A	Room 19, Drinking Fountain, Sink
053 CF	22821700-053CF23A	Room 19, Classroom Sink
054 CF	22821700-054CF23A	Room 19, Classroom Sink
* 055 WB		Doesn't work
* 056 DW		Doesn't work
057 BF	22821700-057BF23A	Girls RR, West Hallway, South Sink (1)
058 BF	22821700-058BF23A	" " " " " " " " " " " "
059 BF	22821700-059BF23A	" " " " " " " " " " " "
060 BF	22821700-060BF23A	" " " " " " " " " " " "
061 WB	22821700-061WB23A	West Hallway, Fill Station @ Drinking Fountain
062 DW	22821700-062DW23A	West Hallway, Drinking Fountain
063 BF	22821700-063BF23A	Boys RR, West Hallway, South Sink (1)
064 BF	22821700-064BF23A	" " " " " " " " " " " "
065 BF	22821700-065BF23A	" " " " " " " " " " " "
066 BF	22821700-066BF23A	" " " " " " " " " " " "
067 BF	22821700-067BF23A	Boys RR, Vestibule, South Sink (1)
068 BF	22821700-068BF23A	" " " " " " " " " " " "
069 BF	22821700-069BF23A	" " " " " " " " " " " "
070 SF	22821700-070SF23A	" " " " " " " " " " " "
071 WB	22821700-071WB23A	Upstairs Hallway, Fill station @ Drinking Fountain
072 DW	22821700-072DW23A	" " " " " " " " " " " "
073 BF	22821700-073BF23A	Girls RR, Upstairs, South Sink (1)
074 BF	22821700-074BF23A	" " " " " " " " " " " "
075 BF	22821700-075BF23A	" " " " " " " " " " " "
076 BF	22821700-076BF23A	" " " " " " " " " " " "



ANALYTICAL REPORT

Apex Laboratories, LLC

6700 S.W. Sandburg Street
Tigard, OR 97223
503-718-2323
ORELAP ID: OR100062

PBS Engineering and Environmental Project: Reynolds School District
4412 S Corbett Ave Project Number: Salish Ponds/23514.186
Portland, OR 97239 Project Manager: James Mastanduno Report ID: A3E1862
A3E1862 - 06 16 23 1641

A3E1862

Lead in Drinking Water Testing Program		Reynolds School District	
Date Collected:	5.25.23	PBS Project:	23514.186
School Name:	Salish Ponds	Building Number:	22821700
Analysis Requested:	Lead (Pb) in drinking water		
Relinquished By:	Serendy/Hindole	Date/Time:	05/30/23 / 12:00 PM
Received By:	JW / APEX LABS	Date/Time:	5/30/23 1240
Email Results to:	james.mastanduno@pbsusa.com	Turnaround Time:	10 - Day

	Fixture Number	Sample Number	Room/Location
	077 CF	21311700-077CF23A	Room 23, Classroom side
	078 CF	21311700-078CF23A	Room 24, Classroom side
	079 CF	21311700-079CF23A	Room 26, Classroom side
	080 CF	21311700-080CF23A	Room 29, Classroom side

Apex Laboratories

Jason Woodcock, Project Manager

The results in this report apply to the samples analyzed in accordance with the chain of custody document. This analytical report must be reproduced in its entirety.



ANALYTICAL REPORT

Apex Laboratories, LLC

6700 S.W. Sandburg Street
Tigard, OR 97223
503-718-2323
ORELAP ID: OR100062

PBS Engineering and Environmental 4412 S Corbett Ave Portland, OR 97239	Project: Reynolds School District Project Number: Salish Ponds/23514.186 Project Manager: James Mastanduno	Report ID: A3E1862 - 06 16 23 1641
--	---	---

APEX LABS COOLER RECEIPT FORM

Client: PBS Element WO#: A3E1862

Project/Project #: Salish Ponds 23514.186 22821700

Delivery Info:
 Date/time received: 5/30/23 @ 1240 By: EST
 Delivered by: Apex Client ESS FedEx UPS Radio Morgan SDS Evergreen Other

Cooler Inspection Date/time inspected: 5/30/23 @ 1405 By: EST

Chain of Custody included? Yes No
 Signed/dated by client? Yes No

	Cooler #1	Cooler #2	Cooler #3	Cooler #4	Cooler #5	Cooler #6	Cooler #7
Temperature (°C)	<u>18.3</u>						
Custody seals? (Y/N)	<u>N</u>						
Received on ice? (Y/N)	<u>N</u>						
Temp. blanks? (Y/N)	<u>N</u>						
Ice type: (Gel/Real/Other)	<u>NA</u>						
Condition (In/Out):	<u>OUT</u>						

Cooler out of temp? (Y/N) Possible reason why: Drinking waters
 Green dots applied to out of temperature samples? Yes No
 Out of temperature samples form initiated? Yes No
Sample Inspection: Date/time inspected: 5/31/23 @ 15:46 By: JAM

All samples intact? Yes No Comments: _____

Bottle labels/COCs agree? Yes No Comments: _____

COC/container discrepancies form initiated? Yes No

Containers/volumes received appropriate for analysis? Yes No Comments: _____

Do VOA vials have visible headspace? Yes No NA
 Comments: _____

Water samples: pH checked: Yes No NA pH appropriate? Yes No NA
 Comments: _____

Additional information: _____

Labeled by: JAM Witness: AW Cooler Inspected by: JAM

Form Y-003 R-00

Apex Laboratories

Jason Woodcock, Project Manager

The results in this report apply to the samples analyzed in accordance with the chain of custody document. This analytical report must be reproduced in its entirety.